

 **ITALIANA**<sup>®</sup>  
*f e r r a m e n t a*

# Atacama J

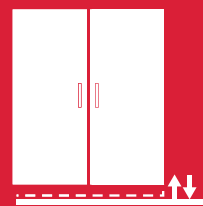

LEVELLERS



# SYMBOLS AND FINISHES LEGEND

## SYMBOLS



= SHELF SAFELY LOCKED DURING TRANSPORTATION AND AT HOME.



= ANTI-TURNOVER LOCKING SYSTEM



= NORMS / PATENTS



= PHILLIPS / POZIDRIV



= WITH BUFFER



= PART NO.



= BLADE SLOT



= WITH MAGNET



= PCS. PER PACKAGE



= COMBI SLOT



= HEXAGONAL SOCKET



= NEWTON



= CAPACITY LOADING



= HEXALOBULAR SOCKET



= FRICTION



= WOOD / GLASS THICKNESS



= COUNTERSUNK HEAD



= AUTOMATIC



= HOLE DIAMETER



= PAN HEAD



= DROP DOWN



= DIAMETER



= FLANGE HEAD



= LENGTH



= FLAT HEAD



= STANDARD HINGE



= HEIGHT



= TRILOBULAR SCREW



= KIMANA HINGE



= RIGHT VERSION



= SELF-TAPPING SCREW



= FLAP HINGE



= LEFT VERSION



= EURO THREAD



= WITH SPRING



= SETTING CODE



= METRIC THREAD



= WITHOUT SPRING



= PCS. PER PAD



= PRE-INSERTED SCREW



= REVERSED SPRING



= CUT ON REQUEST



= PRE-INSERTED SCREW AND SPREADING BUSH



= SELF ADHESIVE



= WITH FLANGE

NOTE: Printing errors and omissions may exist despite our best efforts to ensure accuracy. We reserve the right to alter specifications without notice.

## MATERIALS

**ZA** = Zinc Alloy

**ST** = Steel

**HSS** = High Speed Steel

**BR** = Brass

**ABS** = Acrylonitrile Butadiene Styrene

**ZAnk** = Nickel-plated Zinc Alloy

**STzk** = Zinc-plated Steel

**AL** = Aluminium

**WD** = Wood

**EVA** = Ethylene Vinyl Acetate

**EP** = **ENGINEERING PLASTIC**

+ **EP** = other engineering plastic available on request

**SR** = **SOFT RUBBER**

+ **SR** = other soft rubber available on request

**EPn** = Natural Engineering Plastic

**EPc** = Clear Engineering Plastic

**SRn** = Natural Soft Rubber

**EPw** = White Engineering Plastic

**EPg** = Grey Engineering Plastic

**SRw** = White Soft Rubber

**EPwg** = Water Green Engineering Plastic

**SRb** = Black Soft Rubber



## FINISHES



= OTHER FINISHES AVAILABLE ON REQUEST

PART NO.	FINISHES	PART NO.	FINISHES	PART NO.	FINISHES
<b>00</b>	Insignificant finish	<b>IF</b>	Middle Grey	<b>UT</b>	T-Met 9007
<b>AA</b>	Natural	<b>IJ</b>	Light Grey	<b>UZ</b>	T-Met
<b>AB</b>	White	<b>IL</b>	Grey 20	<b>WA</b>	Bronzed
<b>AE</b>	White 9010	<b>IN</b>	Grey met. 26	<b>WI</b>	Burnished
<b>EA</b>	Black	<b>JB</b>	Bright Aluminium	<b>XD</b>	Satin-finished Steel
<b>EC</b>	Matt Black	<b>JC</b>	Aluminium - Chrome	<b>YA</b>	Nickel-plated
<b>EE</b>	Anthracite	<b>JD</b>	Matt Aluminium	<b>YB</b>	Bright Nickel-plated
<b>EW</b>	Grey 9007	<b>JE</b>	Satin-finished Aluminium	<b>YC</b>	Matt Nickel-plated
<b>FU</b>	Gunmetal	<b>JF</b>	Aluminium - Brass	<b>YD</b>	Satin-finished Nickel-plated
<b>FV</b>	Gunmetal V52	<b>JG</b>	Aluminium 5	<b>YQ</b>	Black Nickel
<b>GR</b>	Raw	<b>JL</b>	Aluminium PE 11	<b>Z9</b>	Black Zinc
<b>HA</b>	Brass-Plated	<b>JM</b>	Aluminium RAL 9006	<b>ZA</b>	Zinc alloy
<b>HH</b>	Tropicalized	<b>KA</b>	Chrome	<b>ZN</b>	Zinc-plated
<b>HL</b>	Raw Brass	<b>KB</b>	Bright Chrome	<b>ZQ</b>	Bright Gold
<b>HX</b>	Graphite	<b>KC</b>	Matt Chrome	<b>ZY</b>	Titanium
<b>IA</b>	Grey	<b>NN</b>	Metallic Beige	<b>ZZ</b>	Clear
<b>IB</b>	Metallic Grey	<b>RO</b>	Red		



## ATACAMA J

**ATACAMA J** is a strong leveller to align heavy duty wardrobes, bookcases and modular furniture with an integrated connecting system.

It is fixed on the furniture bottom through two housings, in order to provide an easier and more stable installation. It is also suitable for 60 mm plinths.

The **ATACAMA J** installation is very easy thanks to a M6 pin that can be screwed into an insert nut placed in the side panel.

A lateral pin slots into the furniture side to achieve a structural connection, as well as an equal load distribution over the furniture side and base. Then, two screws secure Atacama J to the furniture bottom.

A Ø 8 mm through hole in the furniture bottom, allows to connect the bottom panel to the side first and then, by lowering the hexagonal bit of the key, to adjust the height of the construction without interfering with the side connection.

The zinc alloy die-cast foot is provided with an independent engineering plastic glide in order to make the adjustment easier and to prevent the scratching of the floor.

**ATACAMA J** is capable of supporting a 175 kg load each and has 25 mm adjustment.



175 Kg per piece



Tested in accordance with CATAS procedures

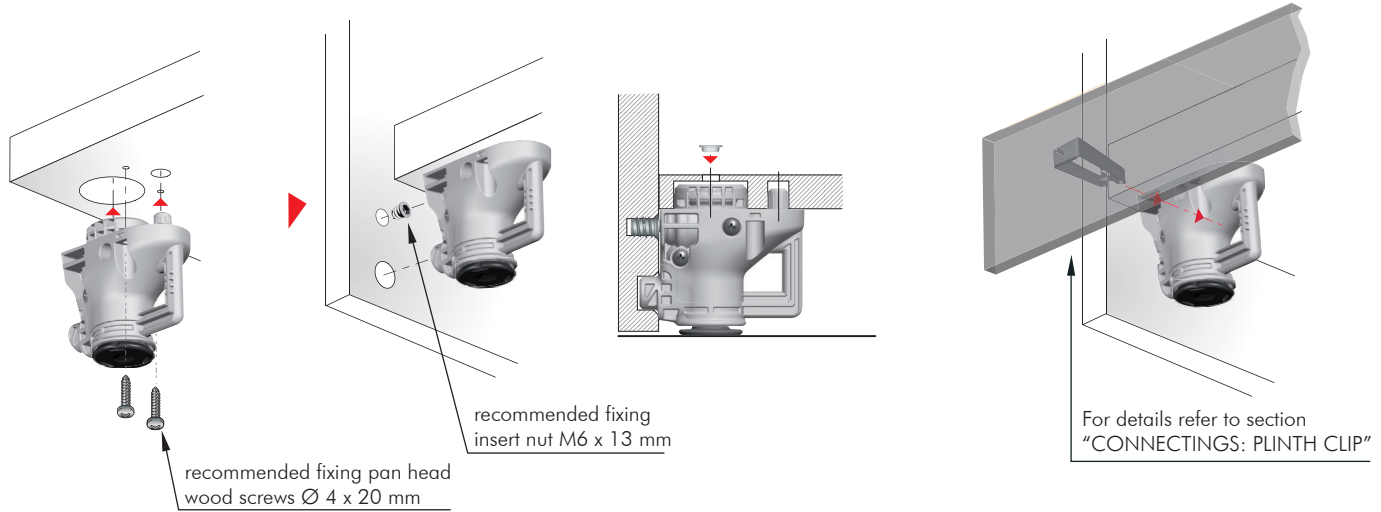

### STEP 1

Special S6 mm allen wrench

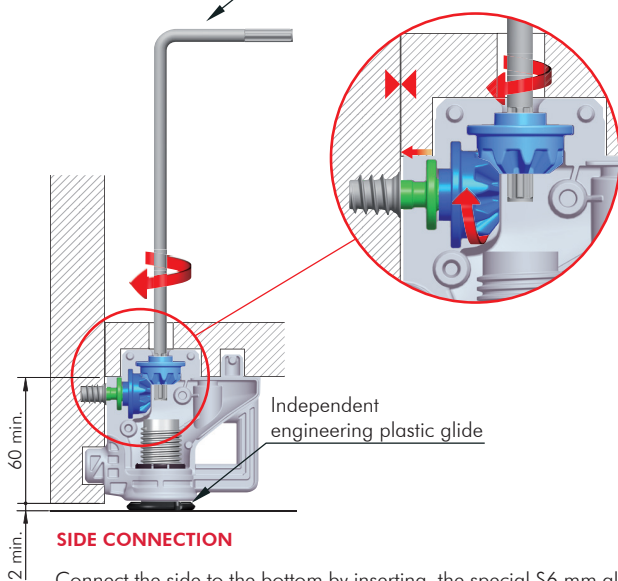

Connect the side to the bottom by inserting the special S6 mm allen wrench with hexagonal bit into the through hole, until it fits into the first cavity.

### STEP 2

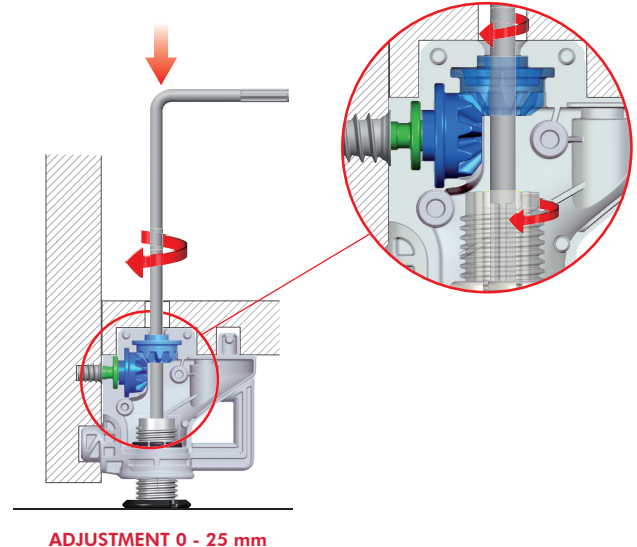

Adjust the height of the construction by lowering the hexagonal bit until it fits the cavity of the die-cast foot.



**ATACAMA J : APPLICATION FOR SIDE PANEL**

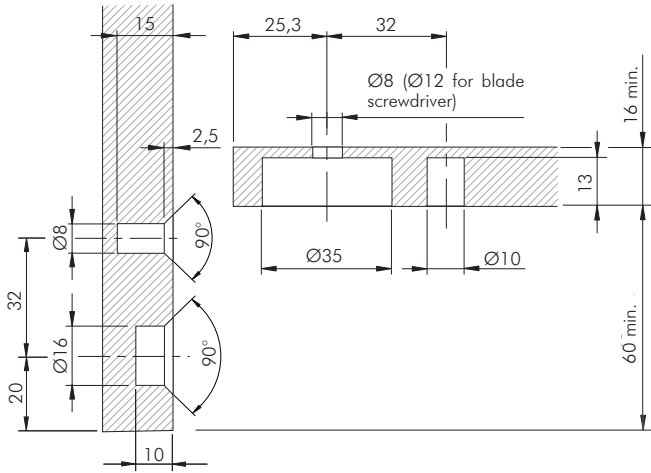

= M6    = special S6  
        = 70 pcs.  
 123

**31701000IJ**

Special allen wrench is required part.no 31702000ZN.

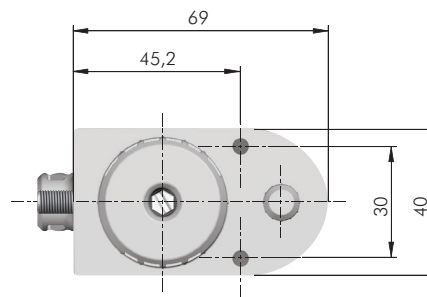
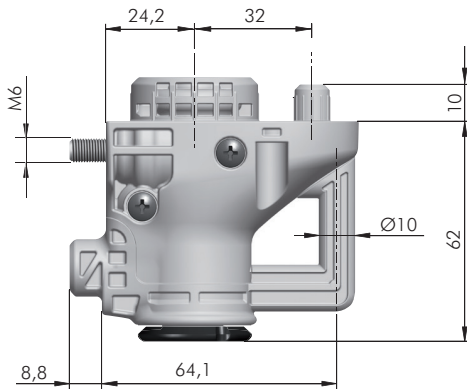

**ATACAMA J FIXING ACCESSORIES FOR SIDE PANEL**

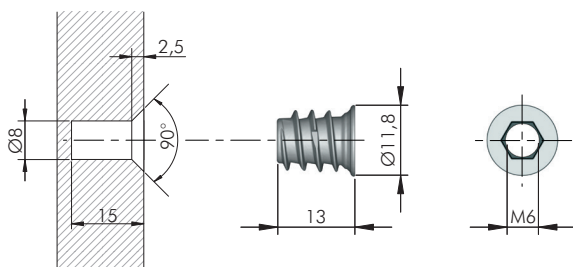

= Ø 8 mm    +   
   = M6    = S6  
    = 5000 pcs.  
 123

**20102020GR**

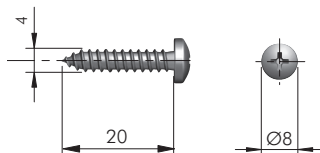

    = PZ2    +   
    = 500 pcs.  
 123

**60103270ZN**



LEVELLERS

# ATACAMA J





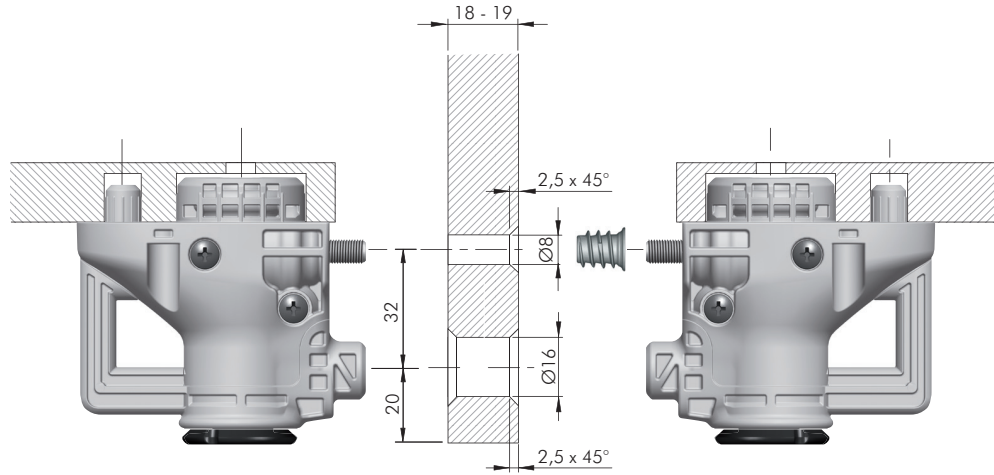

**ITALIANA**  
ferramenta

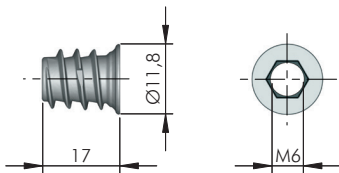
## ATACAMA J: APPLICATION FOR PARTITION 18 - 19 mm THICK



## ATACAMA J FIXING ACCESSORIES FOR PARTITION 18 - 19 mm THICK







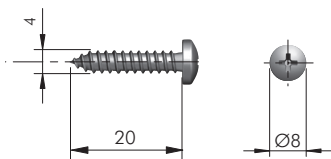

	= Ø 8 mm	
	= M6	
	ZA	
		= 5000 pcs.



20102040GR



			= PZ2	
	ST			= 500 pcs.



60103270ZN



**ATACAMA J: APPLICATION FOR PARTITION 25 mm THICK**

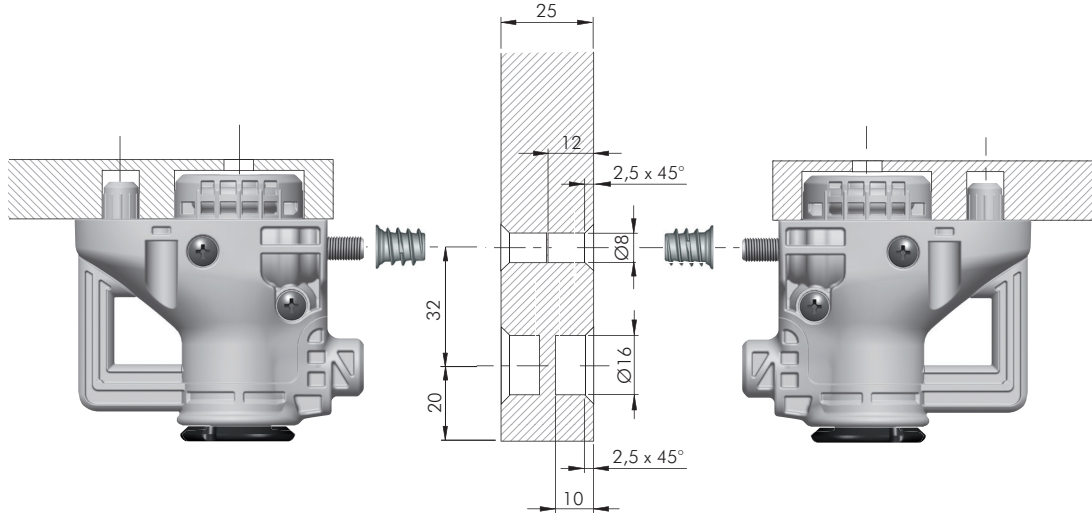

**ATACAMA J FIXING ACCESSORIES FOR PARTITION 25 mm THICK**

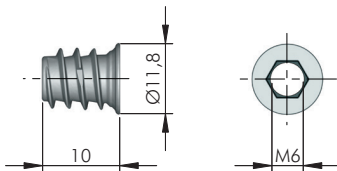

= Ø 8 mm      +

= M6      = S6

= 5000 pcs.

123

**20102010GR**

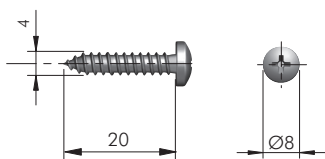

= PZ2      +

= 500 pcs.

123

**60103270ZN**





## ATACAMA J ACCESSORIES

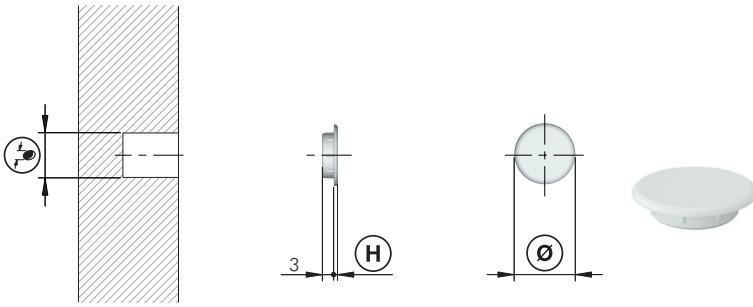

= Ø 8, Ø 12 mm					
EP					
<b>23002010AB</b>	Ø 8	Ø 11	1	5000	
<b>23002030AB</b>	Ø 12	Ø 15	1	5000	

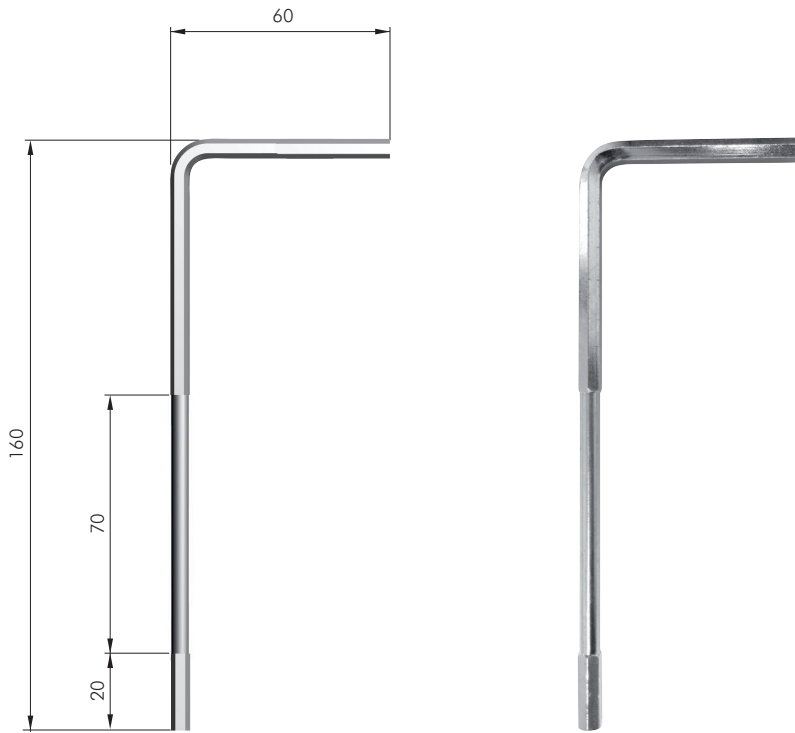

= special S6 mm			= on request
ST			
<b>31702000ZN</b>			

## PLINTH CLIP FOR ATACAMA J

- For details refer to section "CONNECTINGS: PLINTH CLIP"

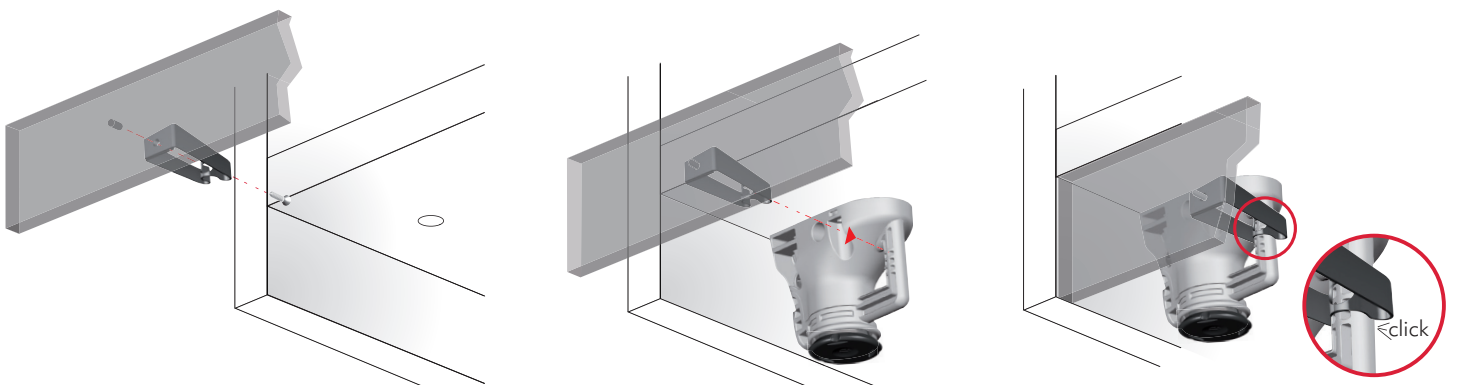







LEVELLERS

# ATACAMA J

**ITALIANA**  
ferramenta

## DRILL BIT FOR ATACAMA J

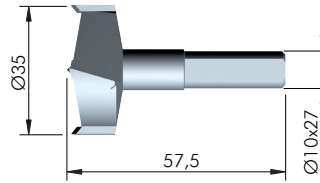
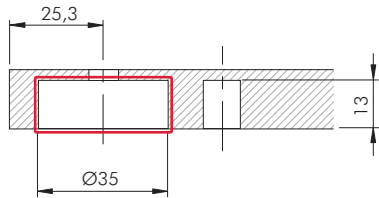
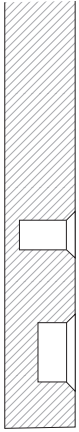

HSS	= on request
123	
<b>3175201000</b>	

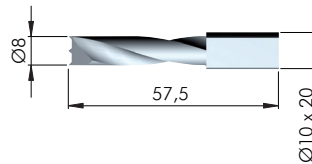
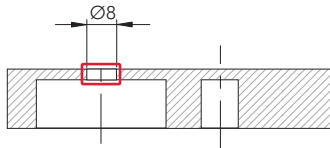
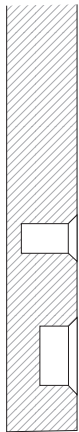

HSS	= on request
123	
<b>1145202000</b>	

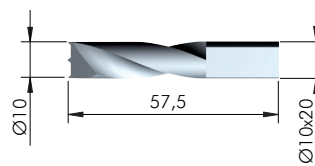
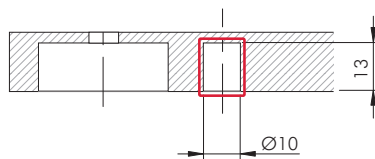
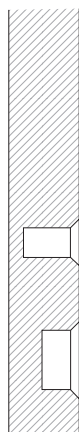

HSS	= on request
123	
<b>3175204000</b>	

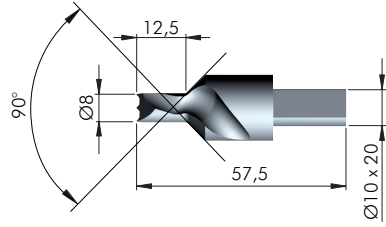
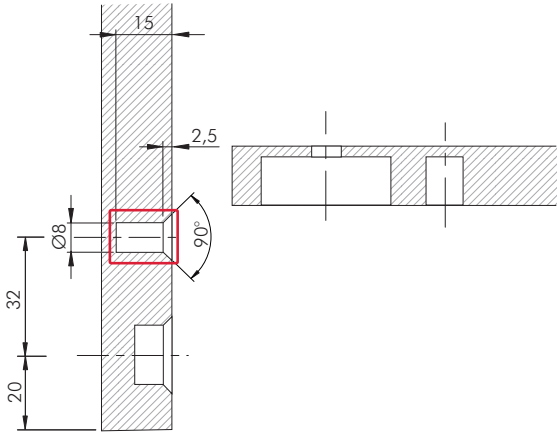

HSS	= on request
123	
<b>3175205000</b>	<b>R</b>
<b>3175211000</b>	<b>L</b>

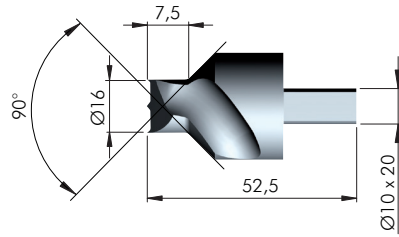
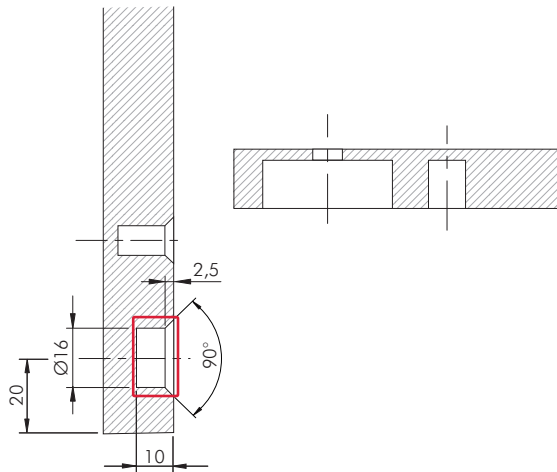

HSS	= on request
123	
<b>3175202000</b>	

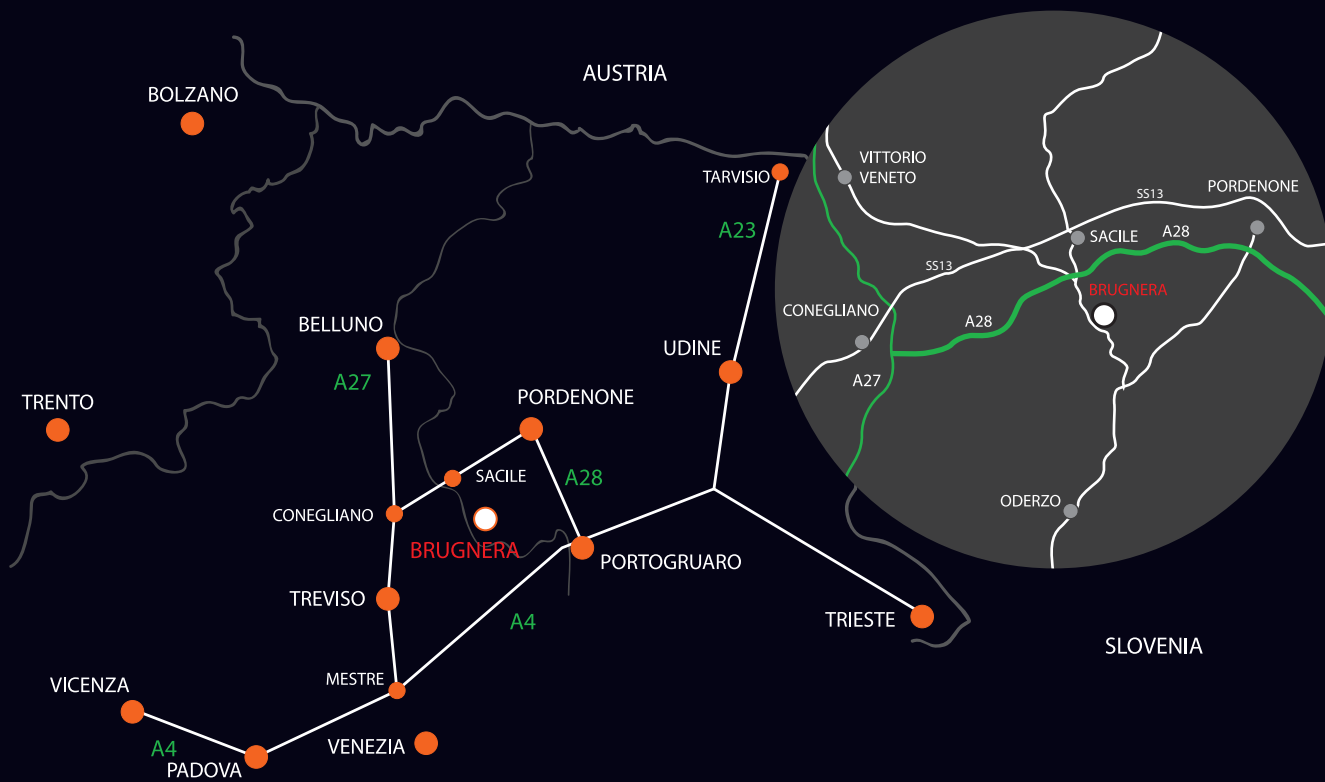

[www.italianaferramenta.com](http://www.italianaferramenta.com)