

## ROKA CHEST OF DRAWERS

### COMPONENTS

PART NO.	DESCRIPTION	QTY
A	Top	1
B	Floor Bottom	1
C	Visible Side Left	1
D	Visible Side Right	1
E	Back Rail	1
F	Back	1
G - V	Drawer sides,back and bottom	16
W,X,Y,Z	Drawer Door Flat Panel	4

### TOOLS REQUIRED

Screw driver	
Mallet	
Measuring tape	

### HARDWARE

ITEM	IMAGE	QTY
Sys5 Cam 3000 15 x 14 mm		18
Sys5 Quickfit TL2 Dowel 8 x 34		18
Wooden Dowel Titus 8 x 30 mm		36
Handle H8429		4
Leg DY1017 Matt Black		4
Screws 3.5 x 16MM		36
Screws 4.0 x 50MM		17
F.Ext Slide 35 x 350MM		4
Anti Tip Safety Strap		2

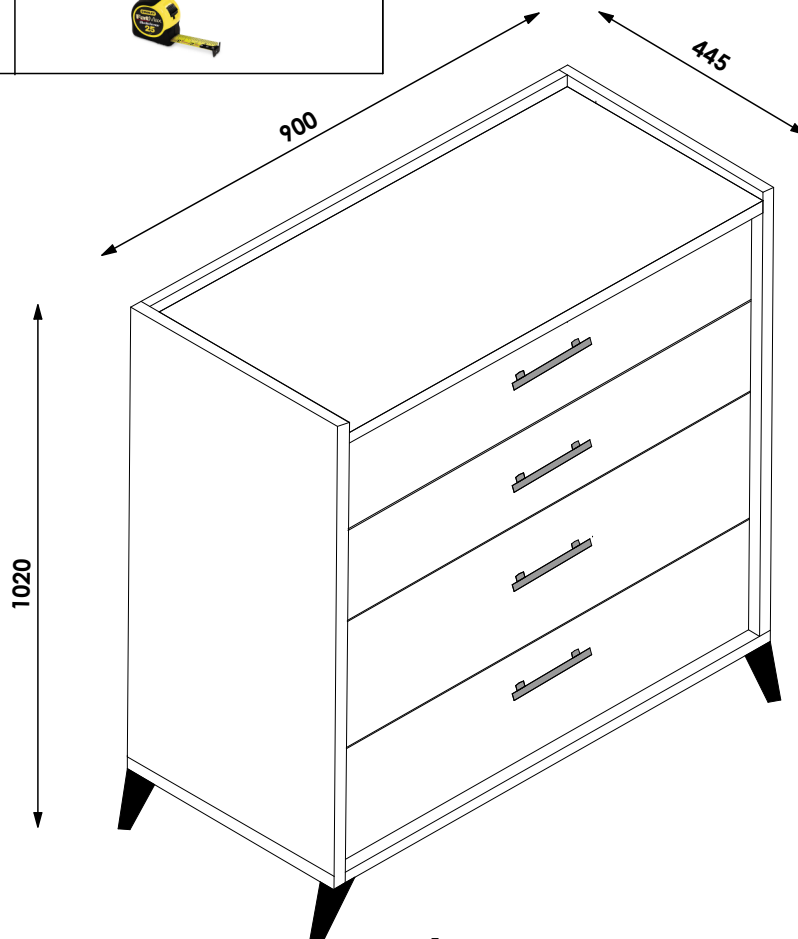

## GENERAL INSTRUCTIONS

1. Confirm that all panels (26) are in the package before assembling.
2. Check the white sticker on each panel for the labelling (A-Z).
3. Ensure that the panels are laid on a non-abrasive surface when assembling.
4. Note that all panel connections are done using the system described below.

### PANEL CONNECTION AND FASTENING

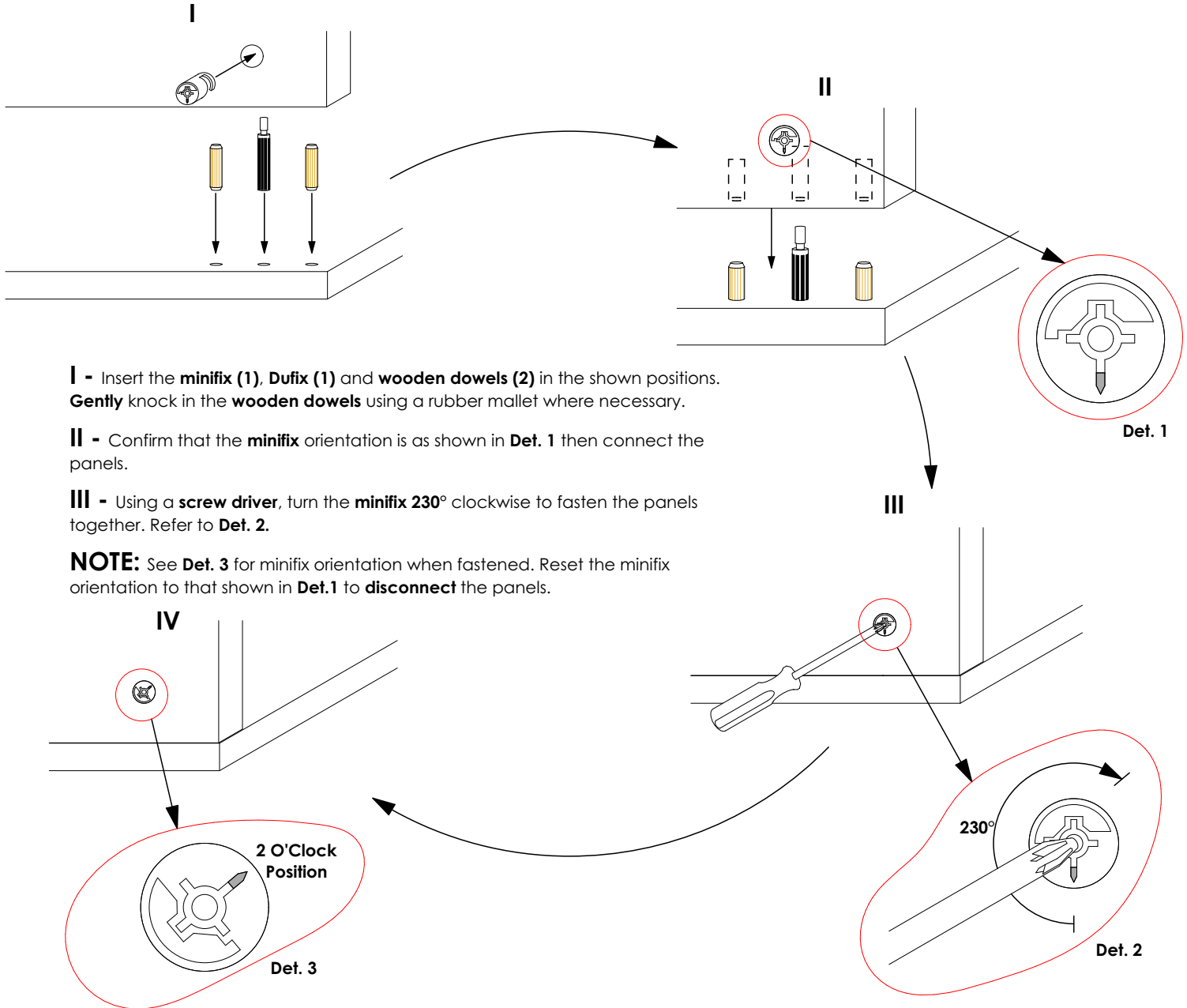

#### For an easy and enjoyable assembly:

Please read the assembly chart completely. Remove all the parts from the carton box and place them on a smooth surface. Make sure you have exactly all the parts and tools listed in the chart. Start assembling the products following the steps on the chart. Please keep the assembly chart for future reference.



**TWO PERSON  
ASSEMBLY  
REQUIRED.**

# ASSEMBLY SHEET - ROKA CHEST OF DRAWERS

## STEP 1

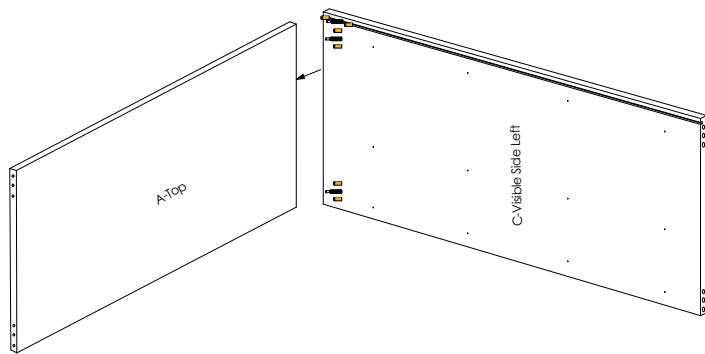

## STEP 2

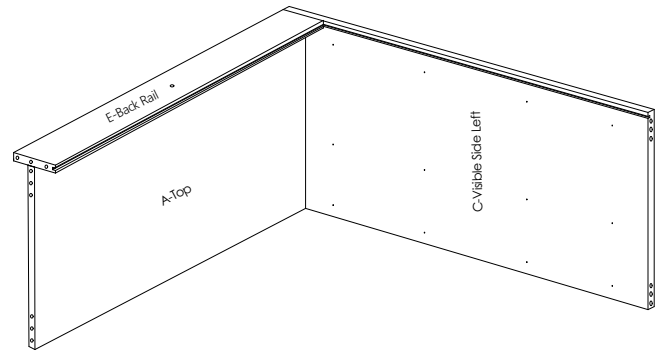

## STEP 3

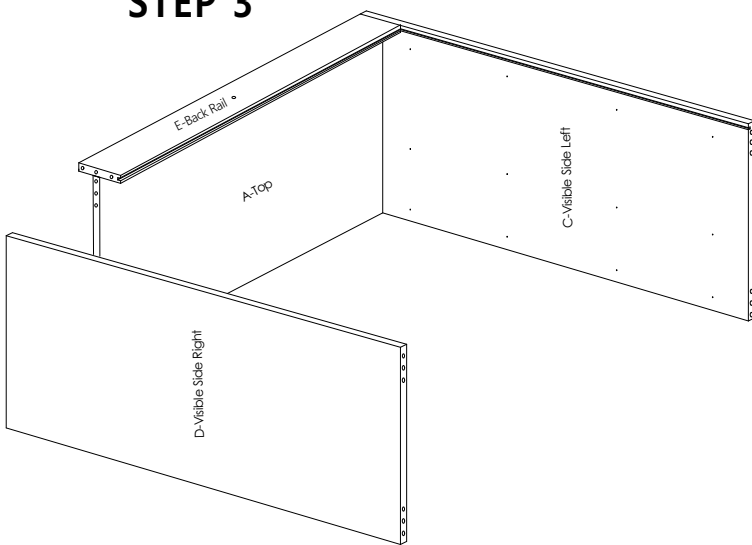

## STEP 4

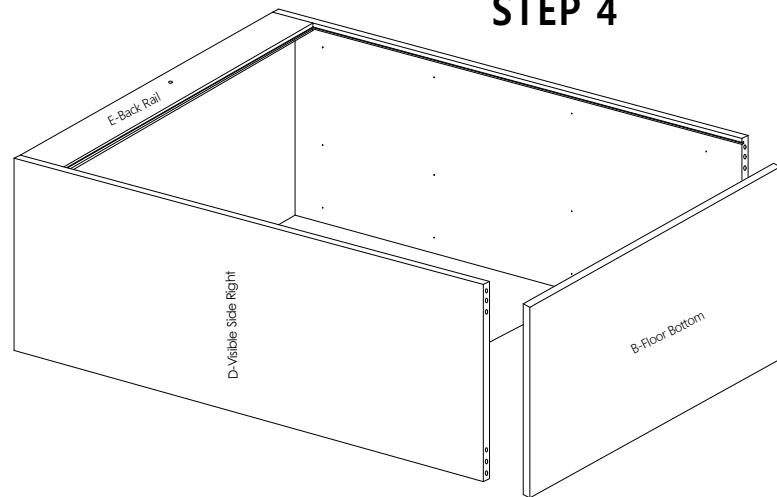

## STEP 5

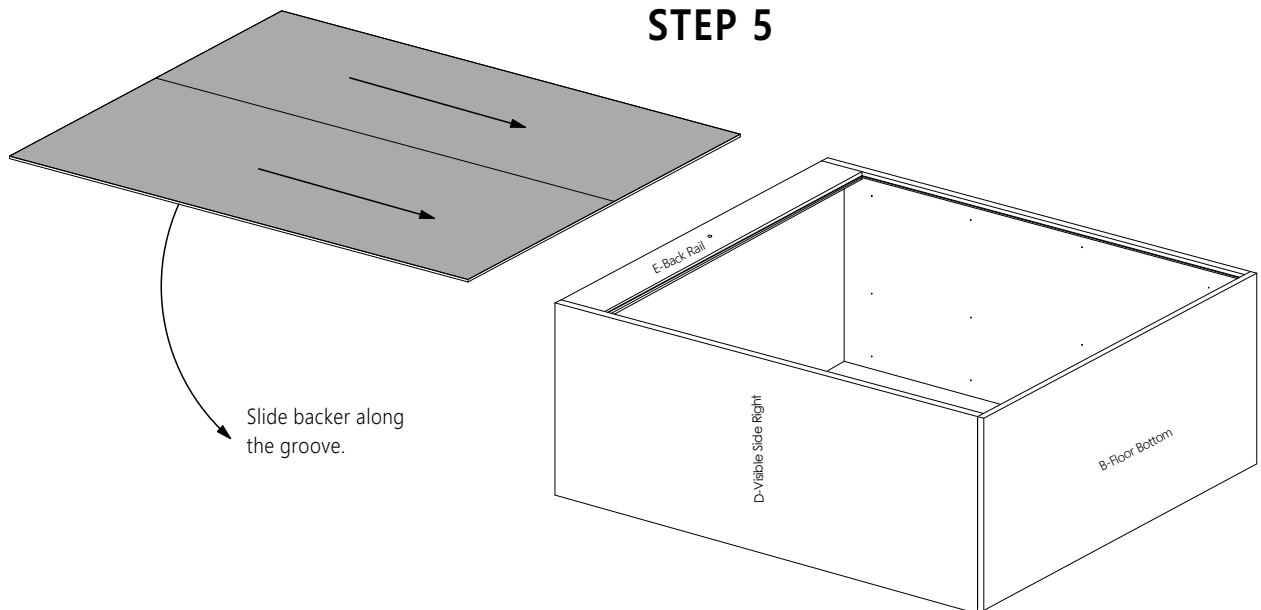

**STEP 6**

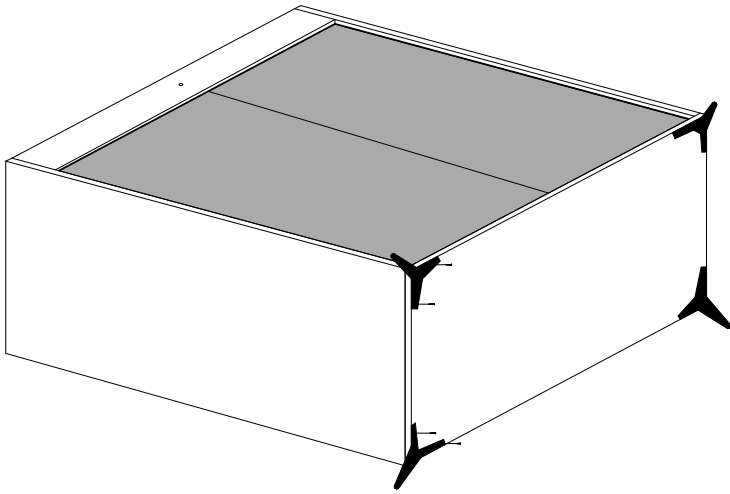

**STEP 7**

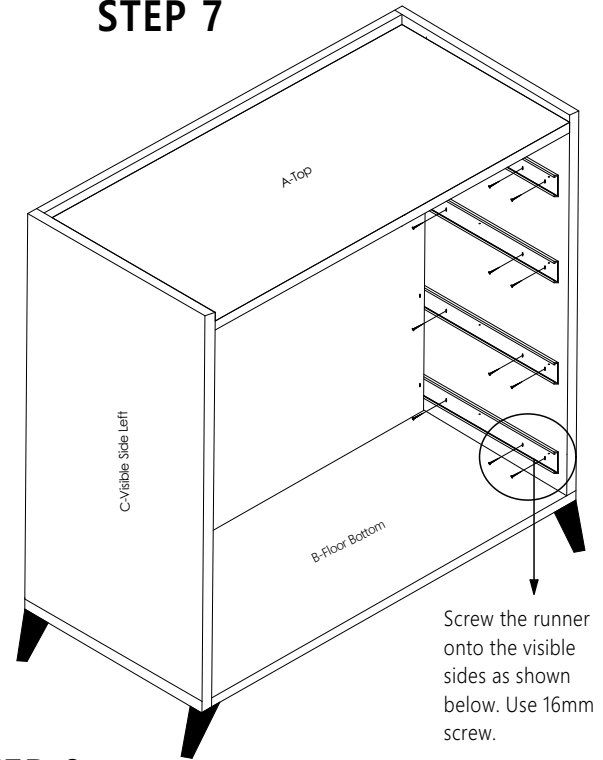

**DRAWER ASSEMBLY**

**STEP 8**

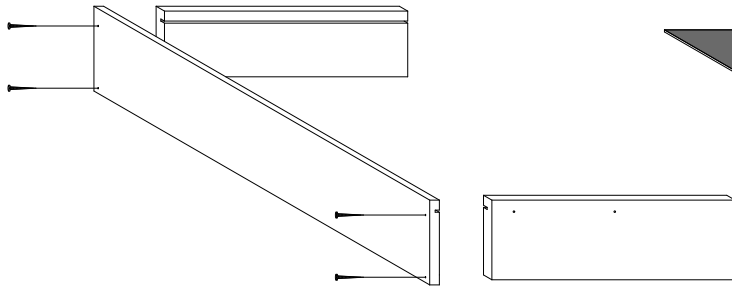

**STEP 9**

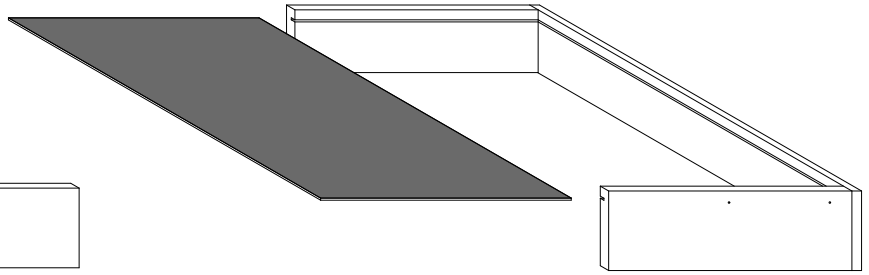

**STEP 10**

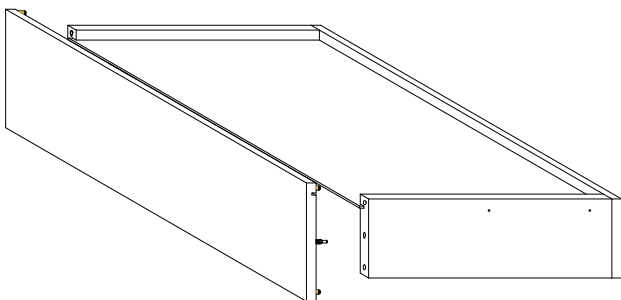

**STEP 11**

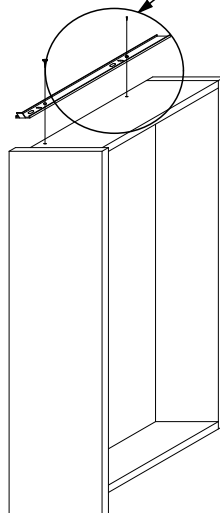

**STEP 12**

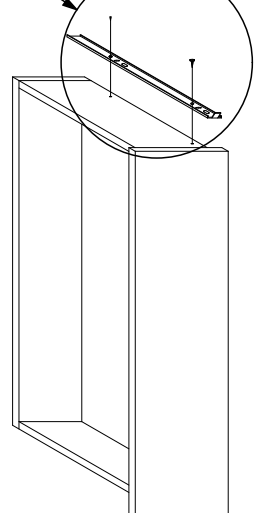

## STEP 13

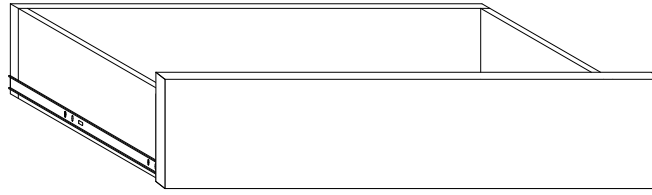

## STEP 14

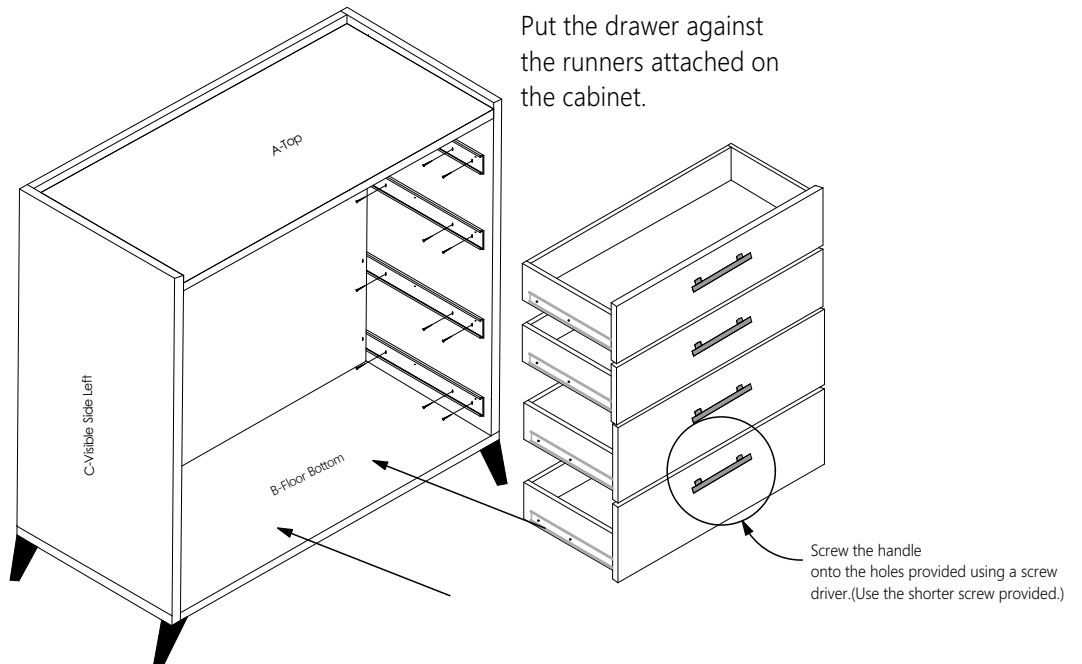

## STEP 15

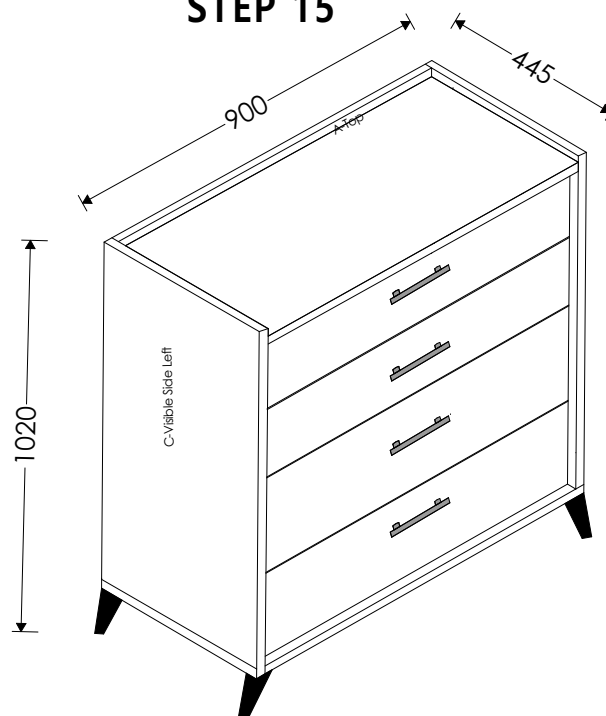

**Prevent furniture tip-over accidents**

**Secure it! Furniture must be securely attached to the wall. Use the tip-over restraint provided with the product and the right hardware for your wall type. Follow our wall anchoring guide for help.**

**Never let children climb or hang on doors or shelves.**

**STEP 10**

