

ROKA TV UNIT 1350MM

COMPONENTS

PART NO.	DESCRIPTION	QTY
A	Top	1
B	Floor Bottom	1
C	Visible Side Left	1
D	Visible Side Right	1
E,F	Adjustable Shelf	2
G,H,I	Door Flat Panel	3
J	Top Rail	1
K	Partition	1
L	Back	1

TOOLS REQUIRED

Screw driver	
Mallet	
Measuring tape	

HARDWARE

ITEM	IMAGE	QTY
Minifix		14
Dufix		14
Dowel		28
Flipper		8
Euro Dowel		8
Handle		3
Inset Hinge		6
Legs		4
Screws 3.5 x 16MM		18
Screws 4.0 x 50MM		1
Glides		2

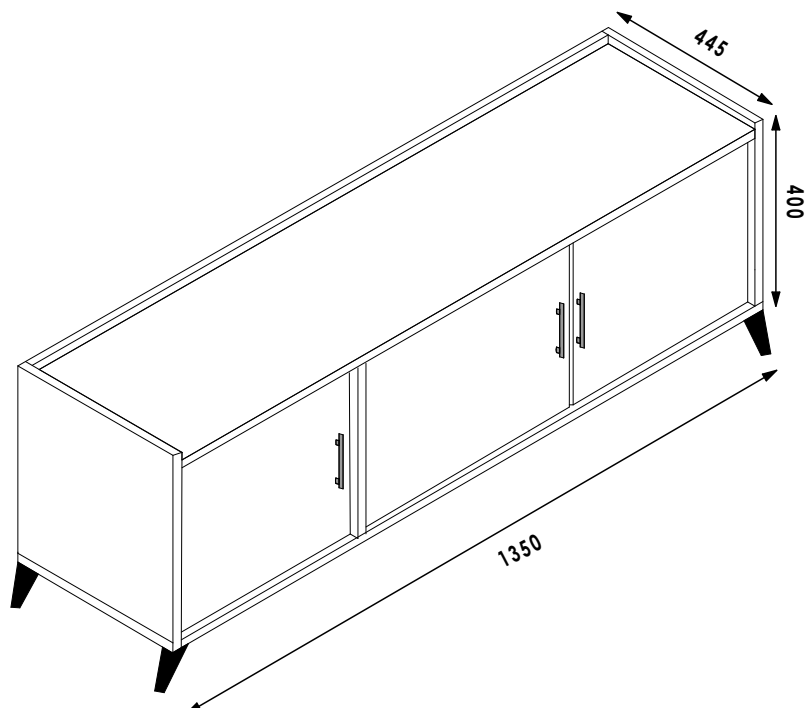

GENERAL INSTRUCTIONS

1. Confirm that all panels (12) are in the package before assembling.
2. Check the white sticker on each panel for the labelling (A,B,C,D,E,F,G,H,I,J,K&L).
3. Ensure that the panels are laid on a non-abrasive surface when assembling.
4. Note that all panel connections are done using the system described below.

PANEL CONNECTION AND FASTENING

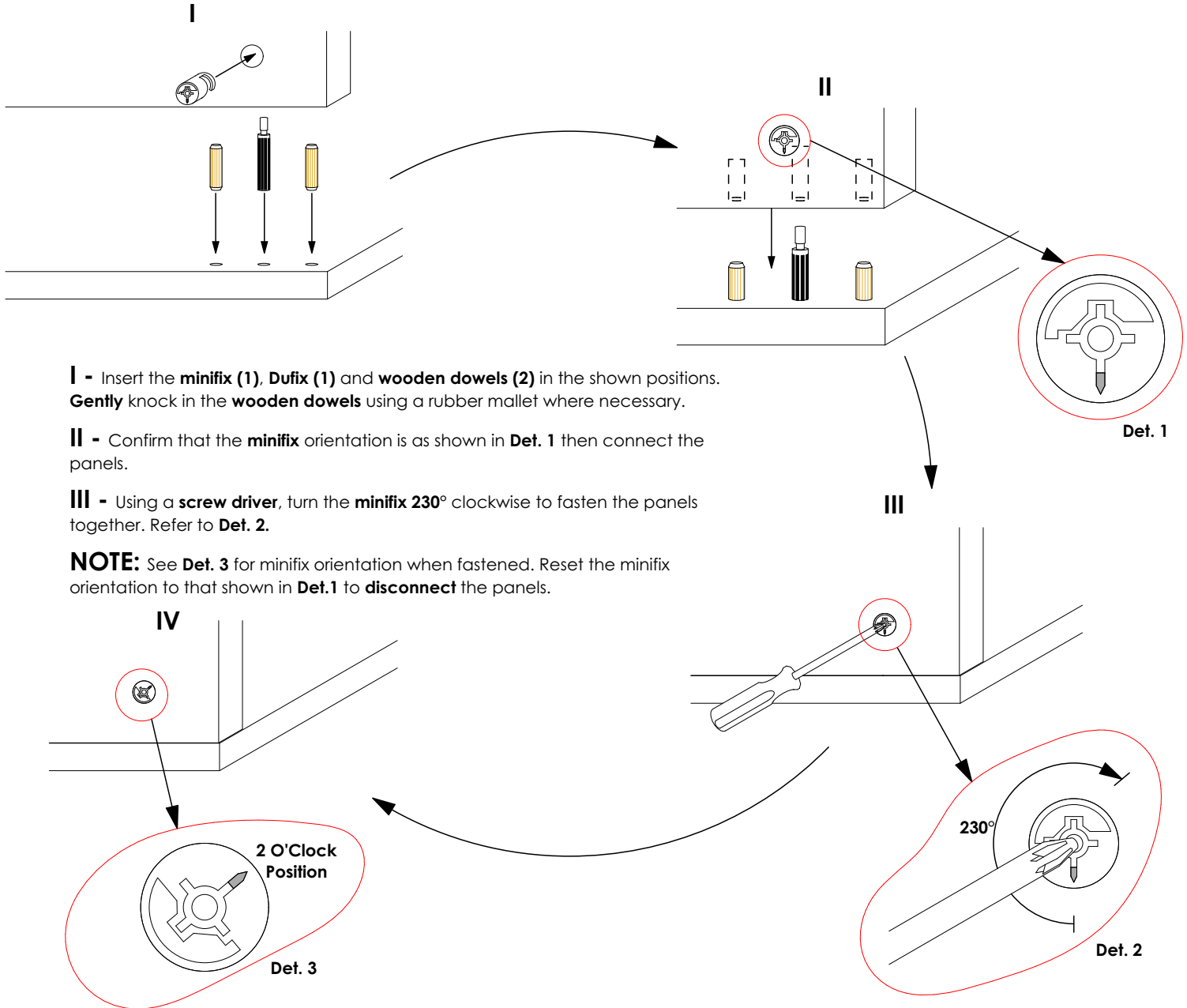

For an easy and enjoyable assembly:

Please read the assembly chart completely. Remove all the parts from the carton box and place them on a smooth surface. Make sure you have exactly all the parts and tools listed in the chart. Start assembling the products following the steps on the chart. Please keep the assembly chart for future reference.



**TWO PERSON
ASSEMBLY
REQUIRED.**

ASSEMBLY SHEET - ROKA TV UNIT 1350MM

STEP 1

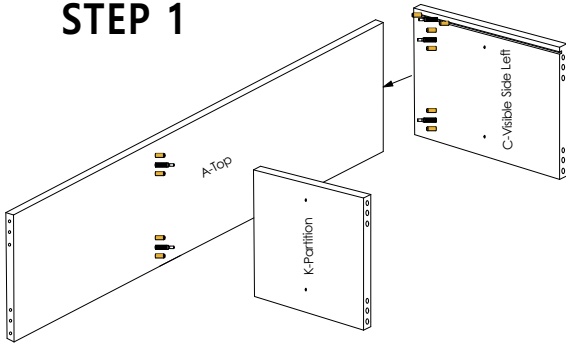

STEP 2

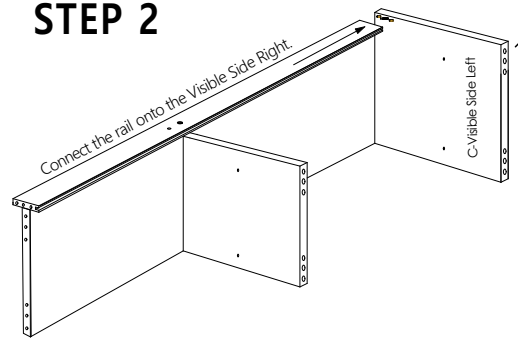

STEP 3

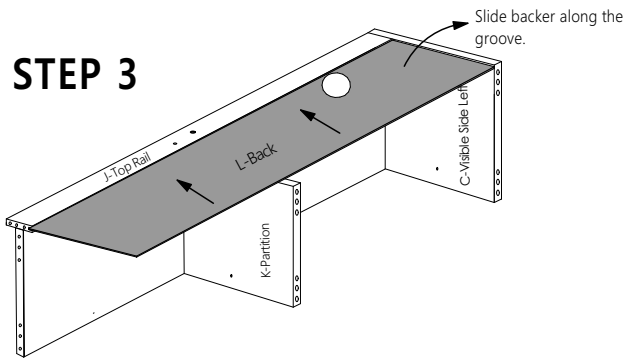

STEP 4

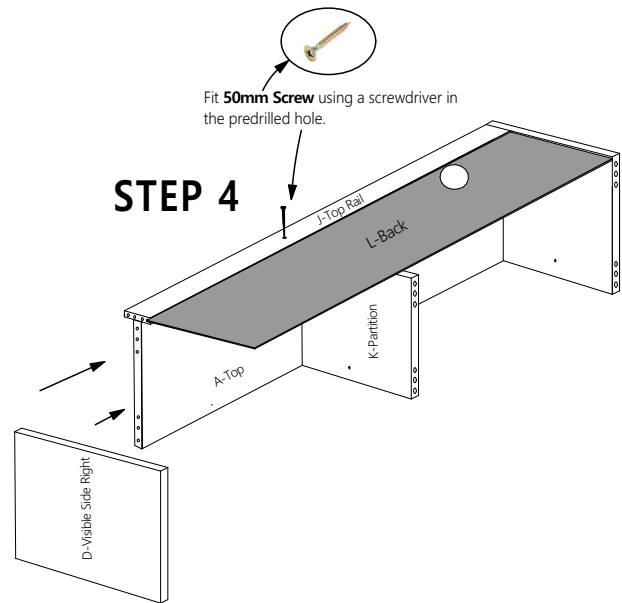

STEP 5

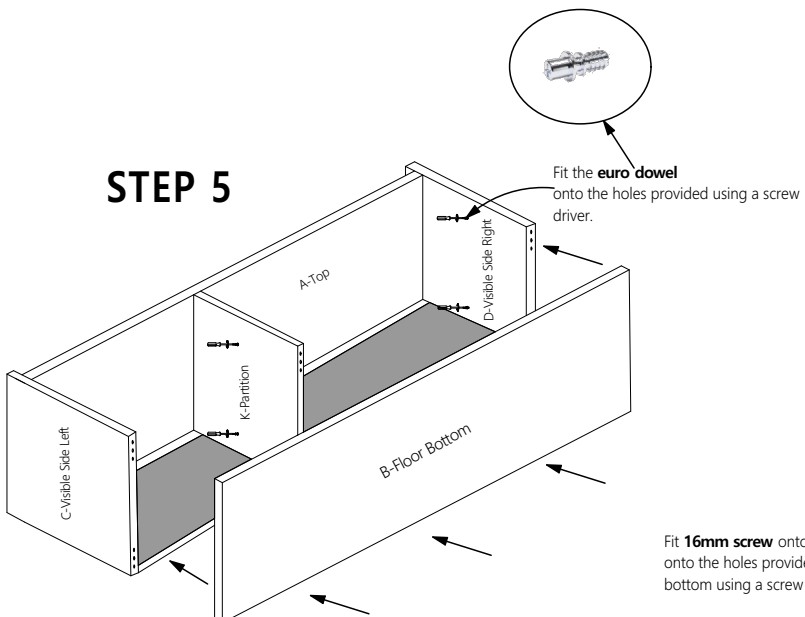

STEP 6

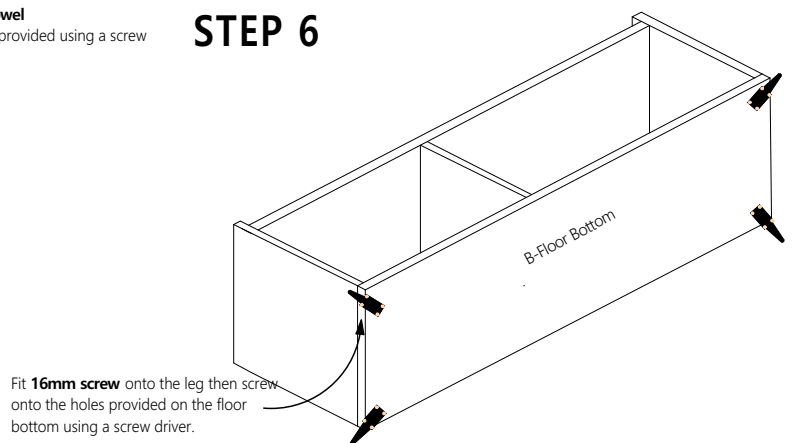

STEP 7

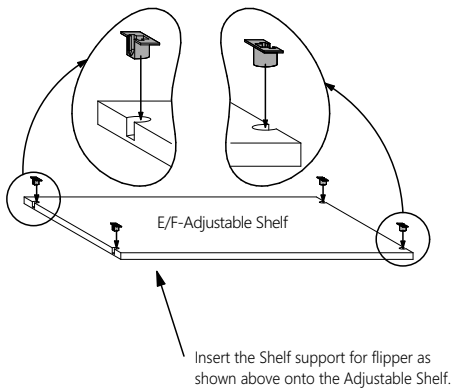

STEP 8

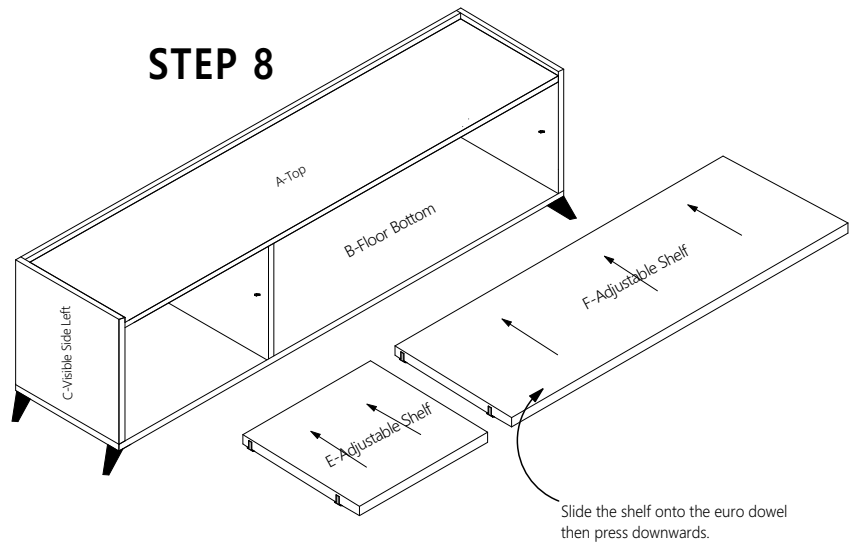

STEP 9

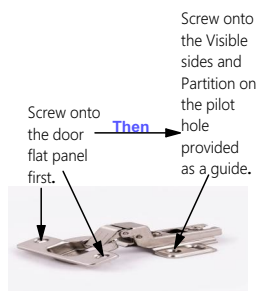
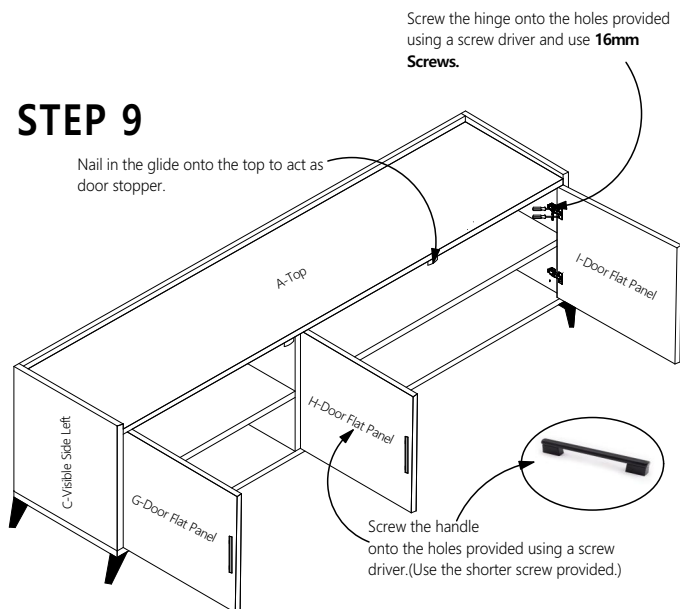

HINGE ADJUSTMENT DETAILS

