

ROKA BOOKCASE WITH DOORS

COMPONENTS

PART NO.	DESCRIPTION	QTY
A	Top	1
B	Floor Bottom	1
C,D,E,F	Shelf	4
G	Visible Side Left	1
H	Visible Side Right	1
I	Back	1
J,K	Door Flat Panel	2

TOOLS REQUIRED

Screw driver	
Mallet	
Measuring tape	

HARDWARE

ITEM	IMAGE	QTY
Minifix		8
Dufix		8
Dowel		16
Flipper		16
Euro Dowel		8
Glides		5
Inset Hinge		6
Screws 3.5 x 16MM		4
Handles		2
Anti Tip Safety Strap		2

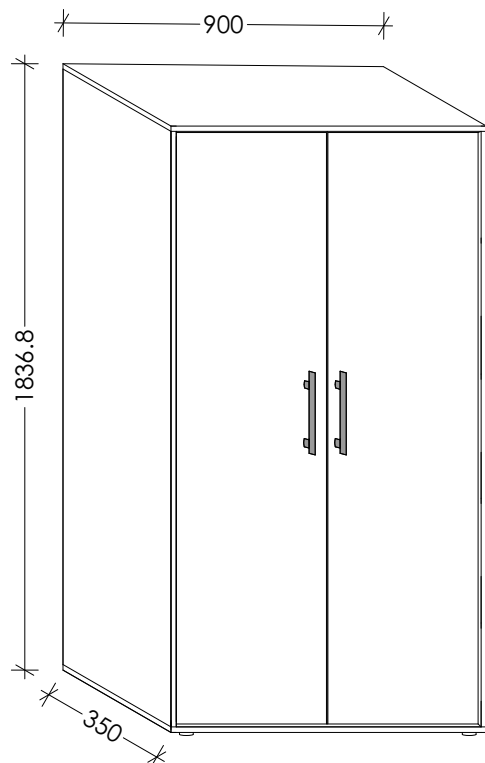

GENERAL INSTRUCTIONS

1. Confirm that all panels (9) are in the package before assembling.
2. Check the white sticker on each panel for the labelling (A,B,C,D,E,F,G,H,I,J&K).
3. Ensure that the panels are laid on a non-abrasive surface when assembling.
4. Note that all panel connections are done using the system described below.

PANEL CONNECTION AND FASTENING

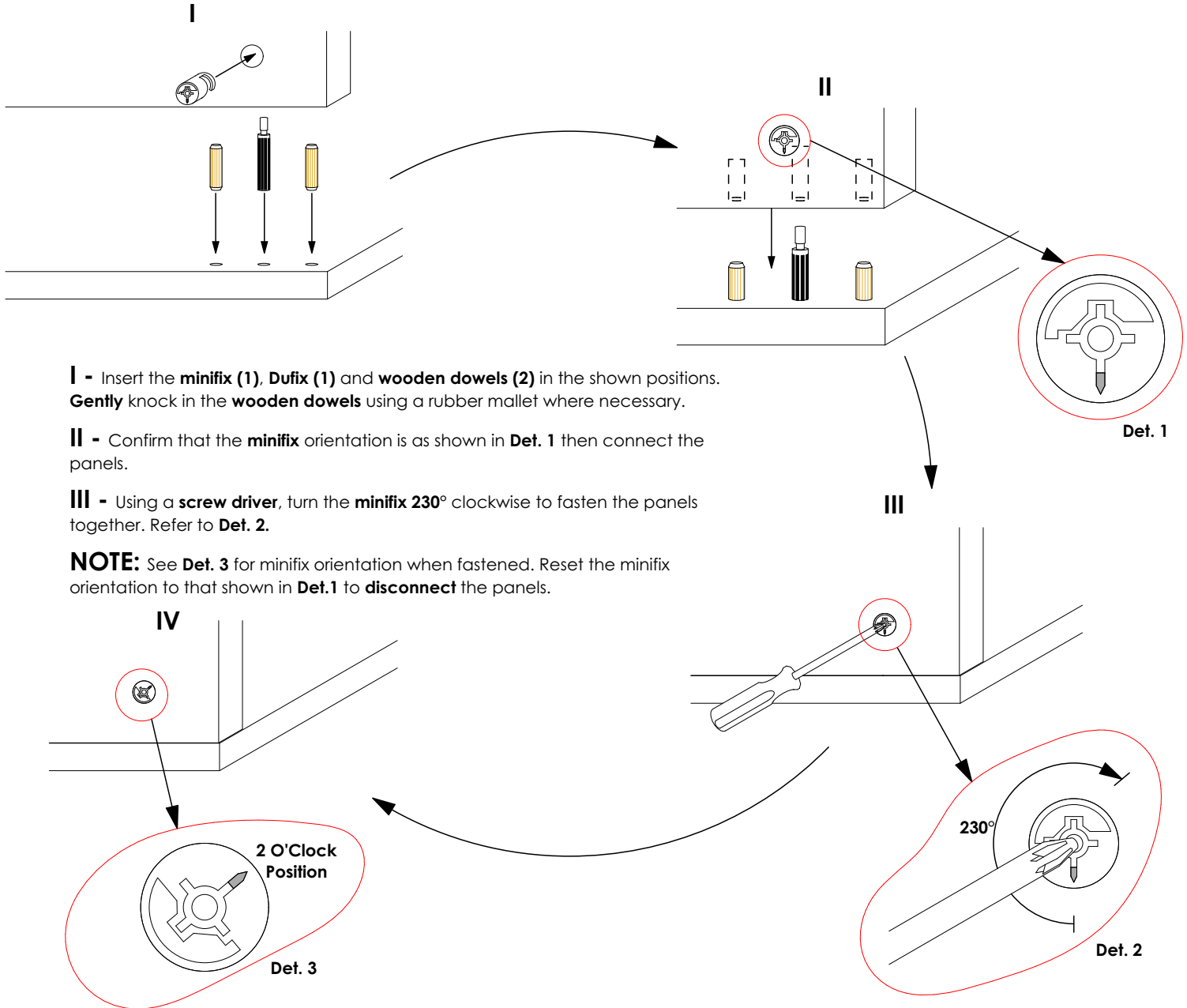

For an easy and enjoyable assembly:

Please read the assembly chart completely. Remove all the parts from the carton box and place them on a smooth surface. Make sure you have exactly all the parts and tools listed in the chart. Start assembling the products following the steps on the chart. Please keep the assembly chart for future reference.



**TWO PERSON
ASSEMBLY
REQUIRED.**

ASSEMBLY SHEET - ROKA BOOKCASE WITH DOORS

STEP 1



STEP 2

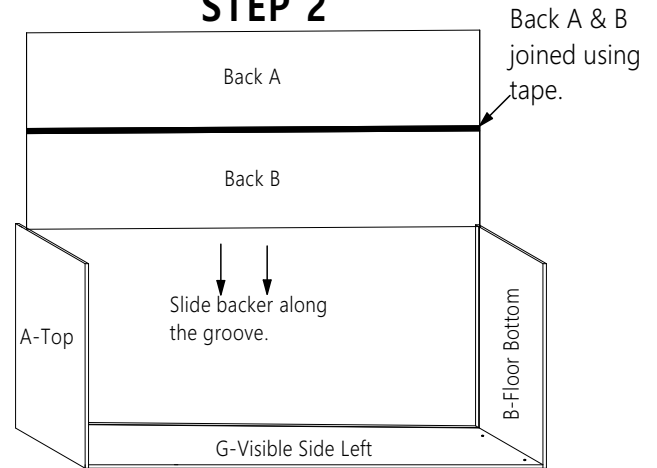

STEP 3

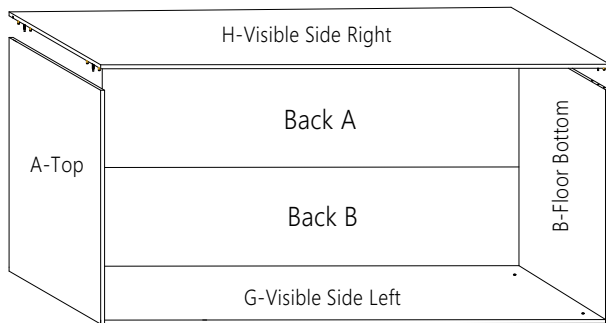

STEP 4

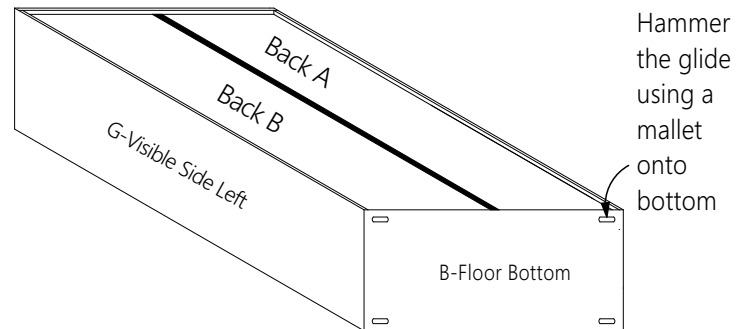

STEP 5

Fix the euro dowel onto the holes provided using a screw driver.

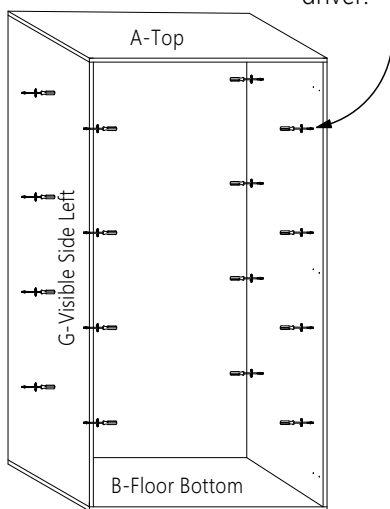

STEP 6

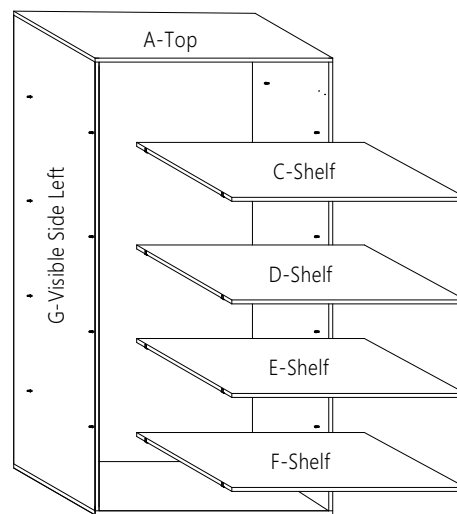

STEP 7

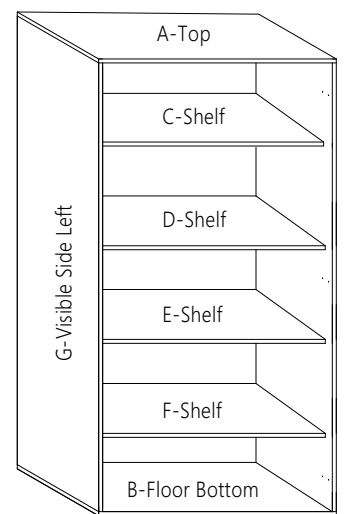

ASSEMBLY SHEET - ROKA BOOKCASE WITH DOORS

STEP 8

Nail in the glide onto the top holes provided to act as door stopper.

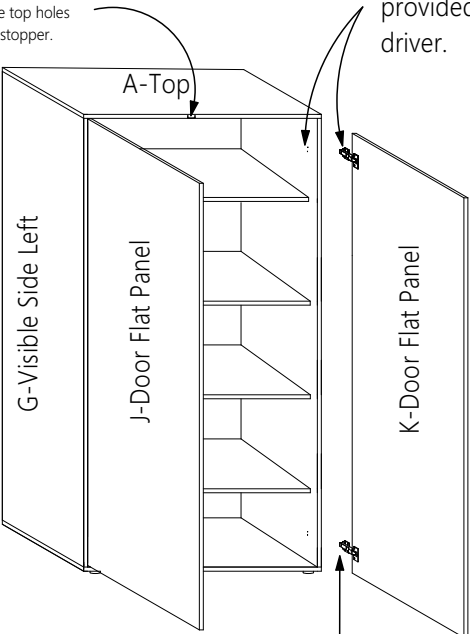

Fix the hinge and hinge plate onto the holes provided using a screw driver.

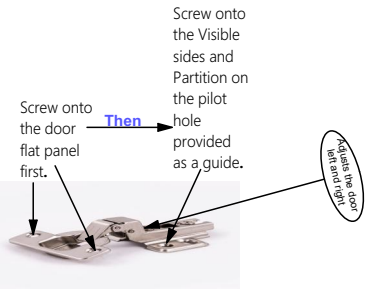

STEP 9

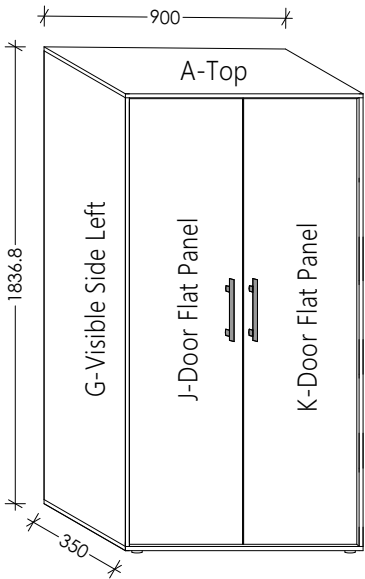

HINGE ADJUSTMENT DETAILS

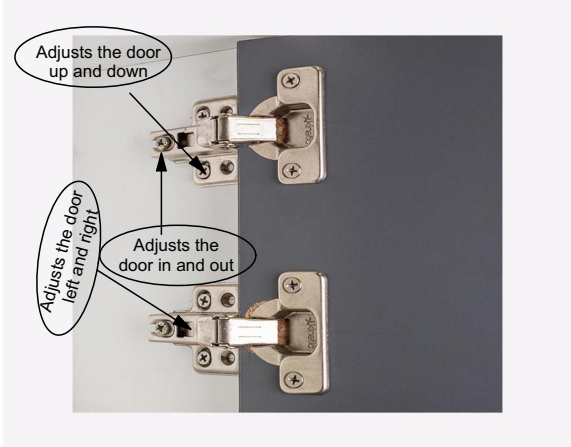

ASSEMBLY SHEET - ROKA BOOKCASE WITH DOORS

Prevent furniture tip-over accidents

Secure it! Furniture must be securely attached to the wall. Use the tip-over restraint provided with the product and the right hardware for your wall type. Follow our wall anchoring guide for help.

Never let children climb or hang on doors or shelves.

STEP 10

