



GEDI TALL STACK CUBE 900mm

COMPONENTS

PART NO.	DESCRIPTION	QTY
A	Top	1
B	Floor Bottom	1
C,D	Adjustable Shelf	2
E	Visible Side Left	1
F	Visible Side Right	1
G,H	Back	2
I	Partition	1

HARDWARE

ITEM	IMAGE	QTY
Sys5 Cam 3000 15 x 14 mm		12
Sys5 Quickfit TL2 Dowel 8 x 34		12
Wooden Dowel Titus 8 x 30 mm		24
Rectangular White Pin		6
Shelf Support PK2 16mm Kit		8

TOOLS REQUIRED

Screw driver	
Mallet	
Measuring tape	

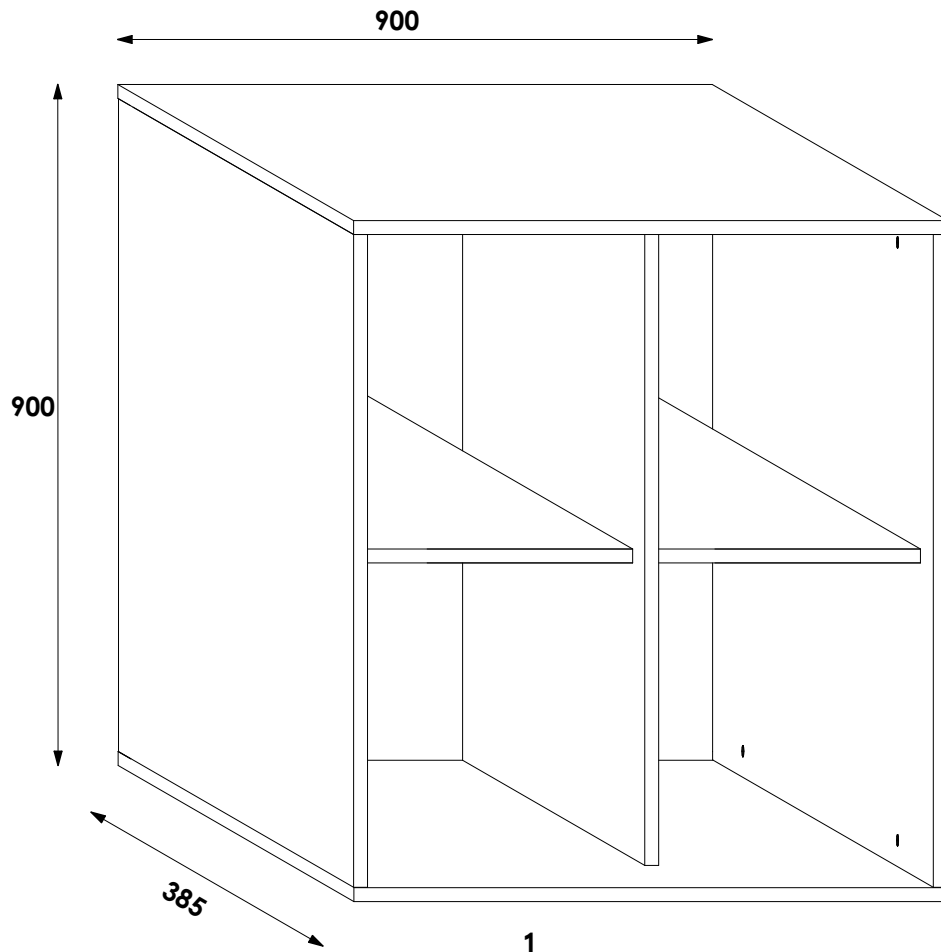

GENERAL INSTRUCTIONS

1. Confirm that all panels (9) are in the package before assembling.
2. Check the white sticker on each panel for the labelling (A,B,C,D,E,F,G,H&I).
3. Ensure that the panels are laid on a non-abrasive surface when assembling.
4. Note that all panel connections are done using the system described below.

PANEL CONNECTION AND FASTENING

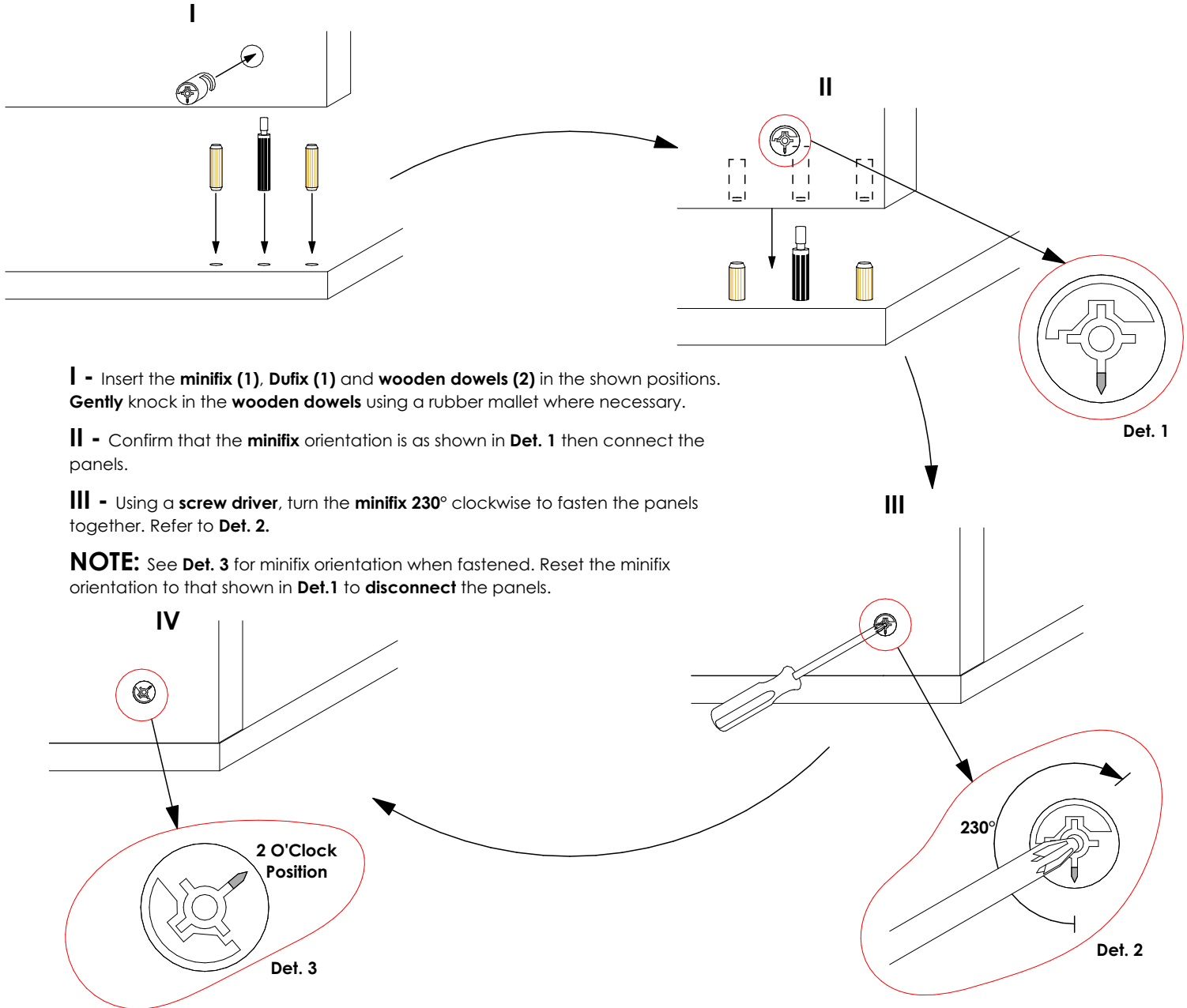

For an easy and enjoyable assembly:

Please read the assembly chart completely. Remove all the parts from the carton box and place them on a smooth surface. Make sure you have exactly all the parts and tools listed in the chart. Start assembling the products following the steps on the chart. Please keep the assembly chart for future reference.



**TWO PERSON
ASSEMBLY
REQUIRED.**

ASSEMBLY SHEET - BOFA STACK CUBE

STEP 1

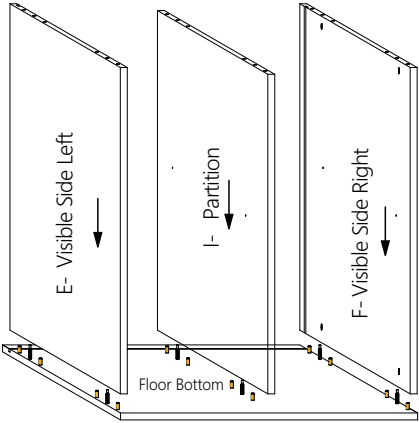

STEP 2

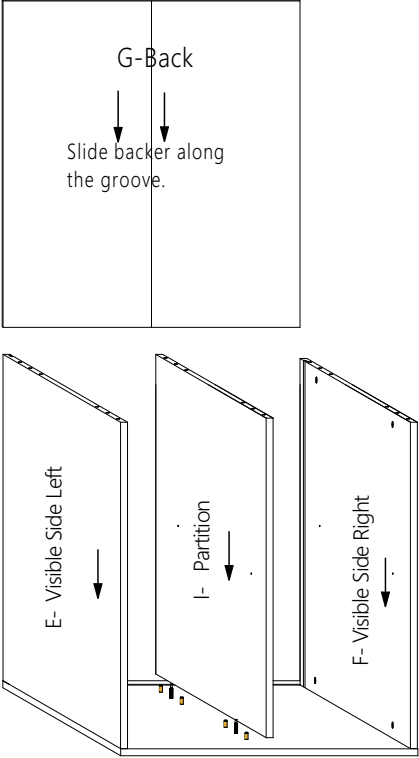

STEP 3

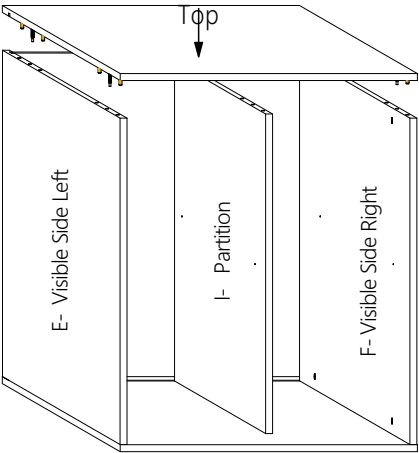

STEP 4

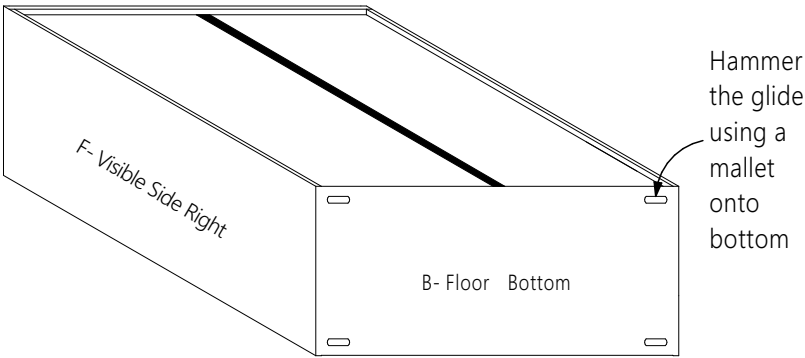

STEP 5

PK2 ASSEMBLY

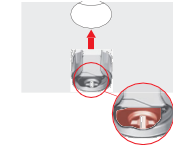
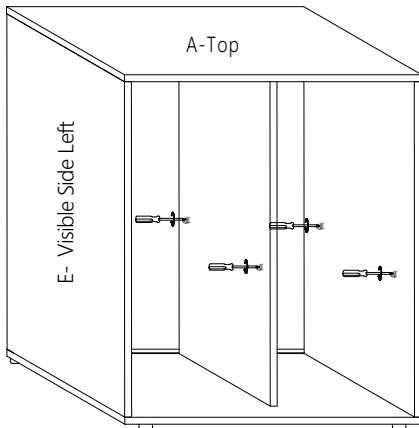

Make sure that the minifix faces downwards.

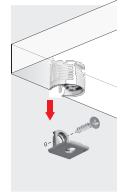

Structural fastening with screwdriver: 90 degrees turning from the upper side, for the furniture floor.

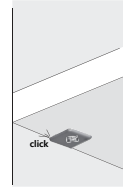

click



Fit the minifix onto the plastic holder.

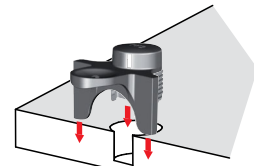

Hammer the minifix onto the predrilled hole on the shelf using a mallet.



STEP 6

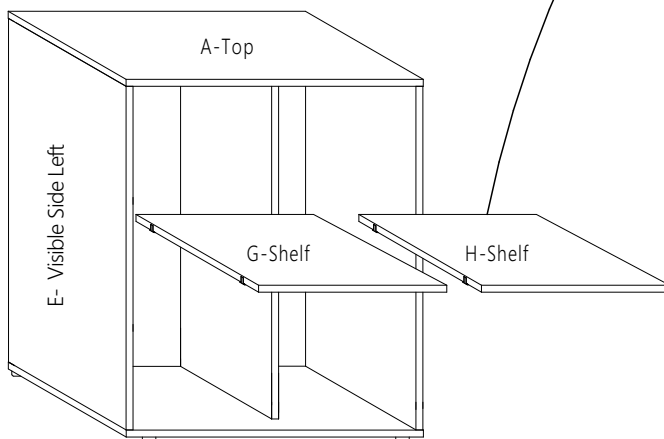

STEP 7

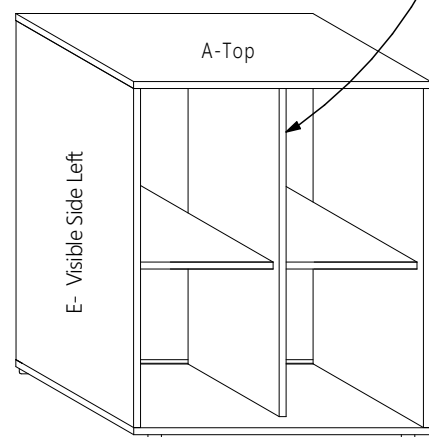

ASSEMBLY SHEET - GEDI TALL STACK CUBE

Kindly note that the Gedi Stack Cube can be mounted on the wall in different angles thus giving various set up ideas as shown below. The APC 1 is not included in the flatpax box therefore if one wants to mount the cube on the wall ,kindly order the APC 1 separately.

STEP 7

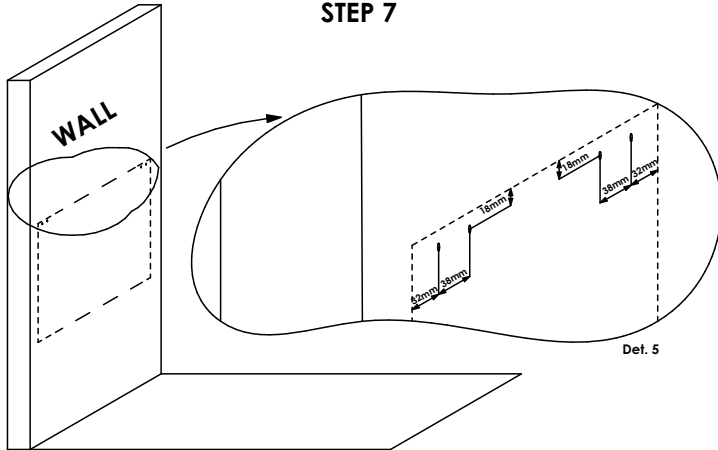

The **broken lines** indicate the **outer boundaries** of the **wall cabinet**. Mark the drill points on the wall with respect to the hanging position of the wall cabinet. Refer to **Det. 5** for dimensions. Then, using an **8mm Drill Bit**, drill **80mm deep** holes through the marked positions on the wall ensuring that the **drill bit** is **perpendicular** to the **wall surface**.

STEP 8

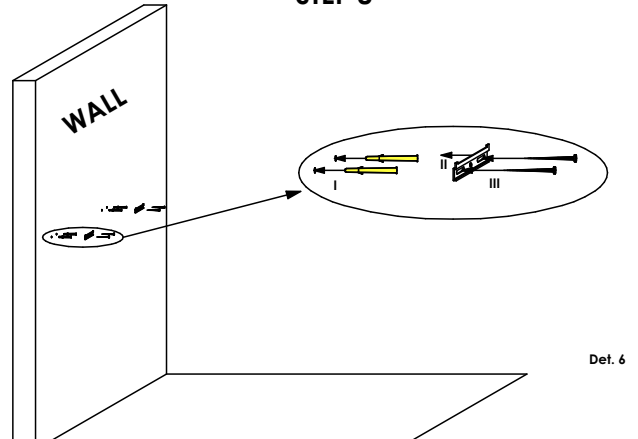

I) Separate the **yellow plug** from the **nail in anchor** and, using a **rubber mallet**, **gently** knock in the plug into the holes drilled in **Step 5**.

II) Place the **APC 1 wall plates** on the wall. Align the oval holes on the wall plate with the plugs.

III) Screw the **nail in anchor** into the **yellow plug**.

6

STEP 9

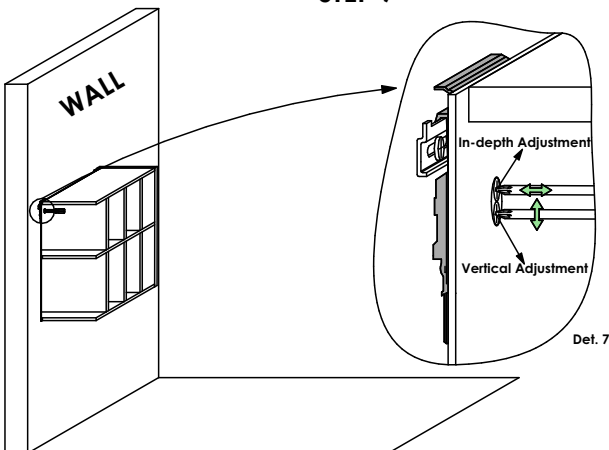

Hang the wall cabinet on the wall by hooking the **APC 1 Hangers** onto the **APC 1 wall plates**.

Also drill a hole onto the backer of the cabinet using the specifications above then see

Det. 7 for **adjustment** details.

BACK PANEL DRILLING SPECS

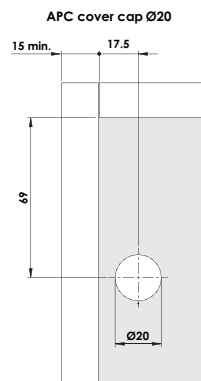

Det. 8

STEP 10

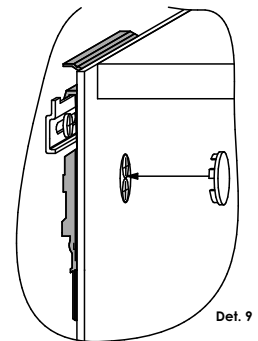

Snap in the **APC 1 cover caps** to conceal the holes on panel **F**. See **Det. 9**

MODULE DESIGNS

Below are module designs that can be used as inspiration to the customer when setting up the gedi cubes.

