

## GEDI TV UNIT 1350MM

### COMPONENTS

PART NO.	DESCRIPTION	QTY
A	Top	1
B	Floor Bottom	1
C	Visible Side Left	1
D	Visible Side Right	1
E,F	Adjustable Shelf	2
G	Door Flat Panel	1
H	Top Rail	1
I	Partition	1
J	Back	1
K,I,M,N	Drawer sides,back and bottom	4
O	Drawer Door Flat Panel	1

### TOOLS REQUIRED

Screw driver	
Mallet	
Measuring tape	

### HARDWARE

ITEM	IMAGE	QTY
Minifix		16
Dufix		16
Dowel		32
Flipper		8
Euro Dowel		8
Handle		2
Inset Hinge		2
legs		4
Screws 3.5 x 16MM		30
Screws 3.5 x 50MM		5
F.Ext Slide 35 x 350MM		1
Glide		1

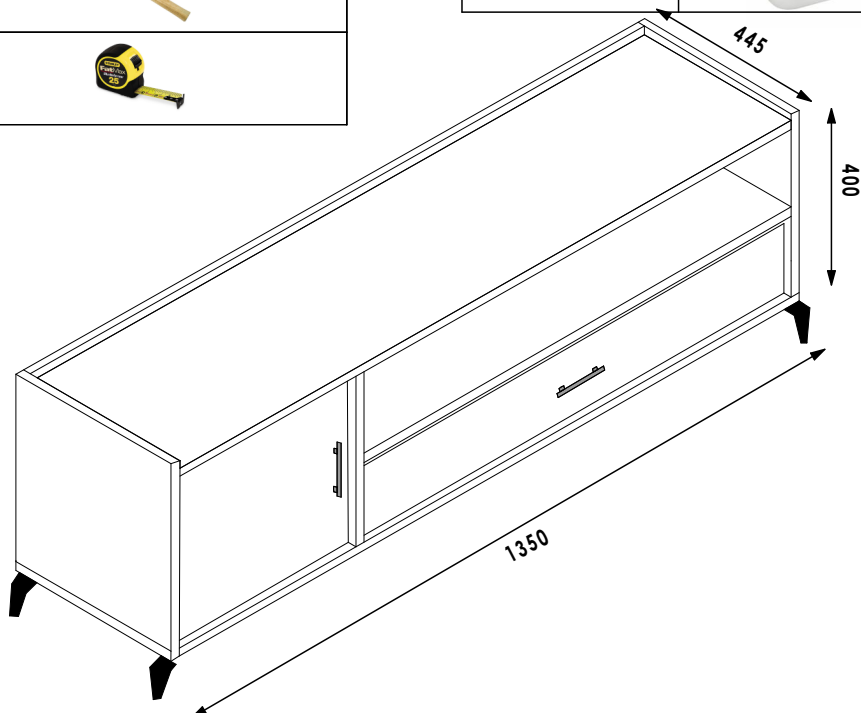

## GENERAL INSTRUCTIONS

1. Confirm that all panels (15) are in the package before assembling.
2. Check the white sticker on each panel for the labelling (A,B,C,D,E,F,G,H,I,J,K,L,M,N & O).
3. Ensure that the panels are laid on a non-abrasive surface when assembling.
4. Note that all panel connections are done using the system described below.

### PANEL CONNECTION AND FASTENING

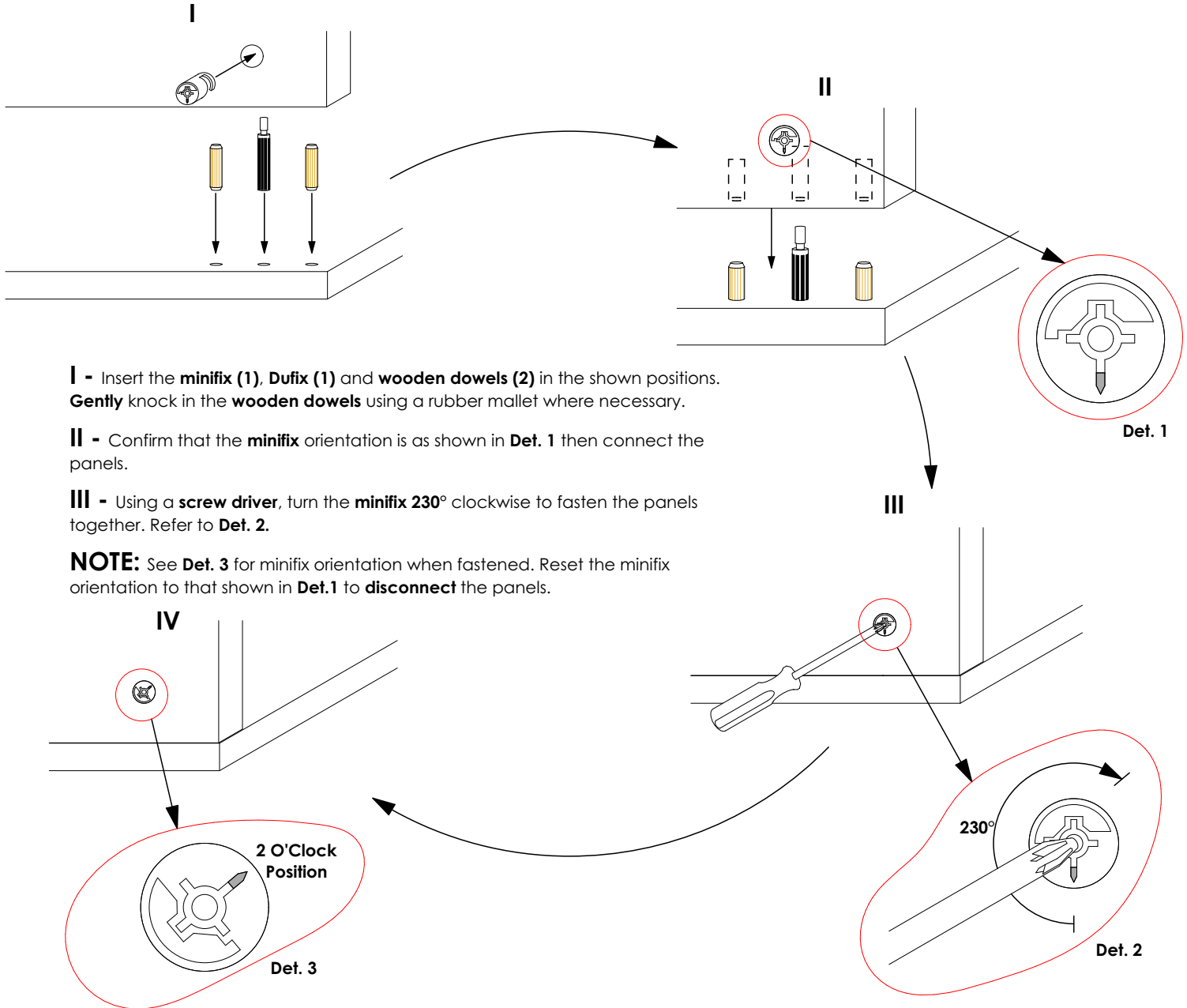

#### For an easy and enjoyable assembly:

Please read the assembly chart completely. Remove all the parts from the carton box and place them on a smooth surface. Make sure you have exactly all the parts and tools listed in the chart. Start assembling the products following the steps on the chart. Please keep the assembly chart for future reference.



**TWO PERSON  
ASSEMBLY  
REQUIRED.**

## STEP 1

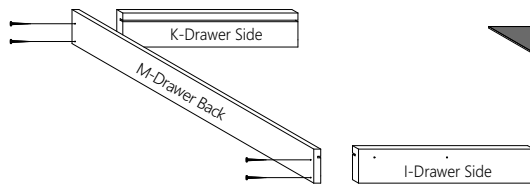

## STEP 2

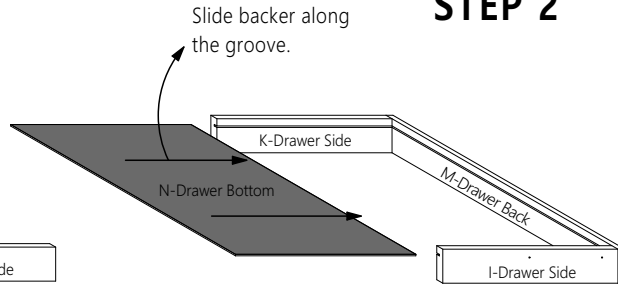

## STEP 3

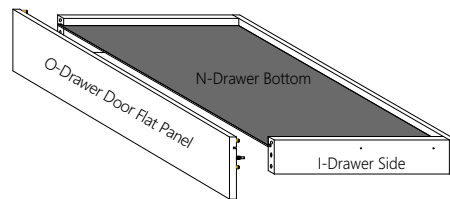

Screw the runner onto the drawer sides as shown below. Use 16mm Screw.

## STEP 4

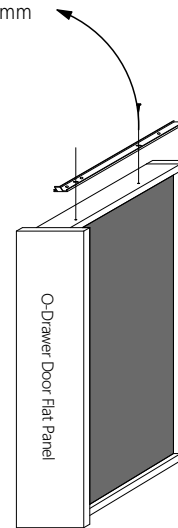

## STEP 5

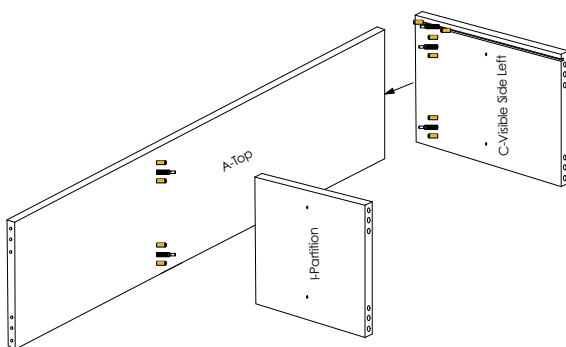

## STEP 6

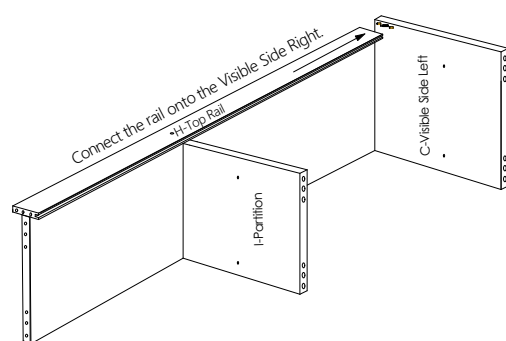

## STEP 7

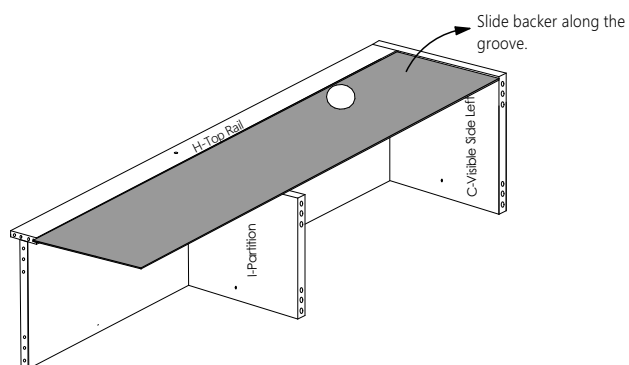

## STEP 8

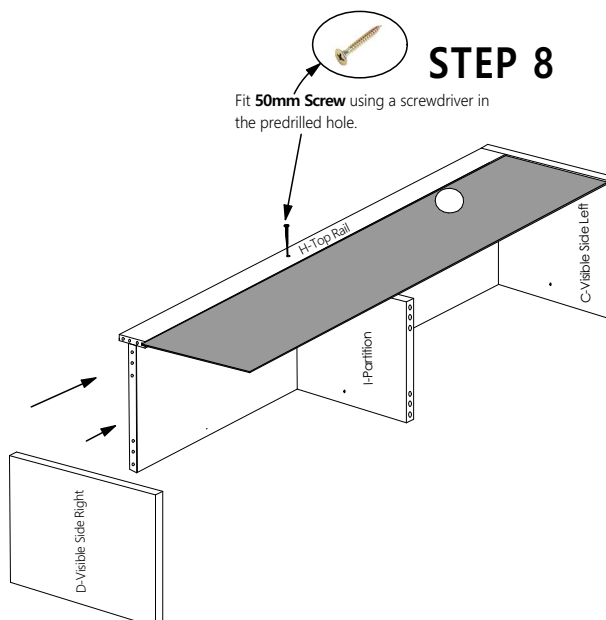

## STEP 9

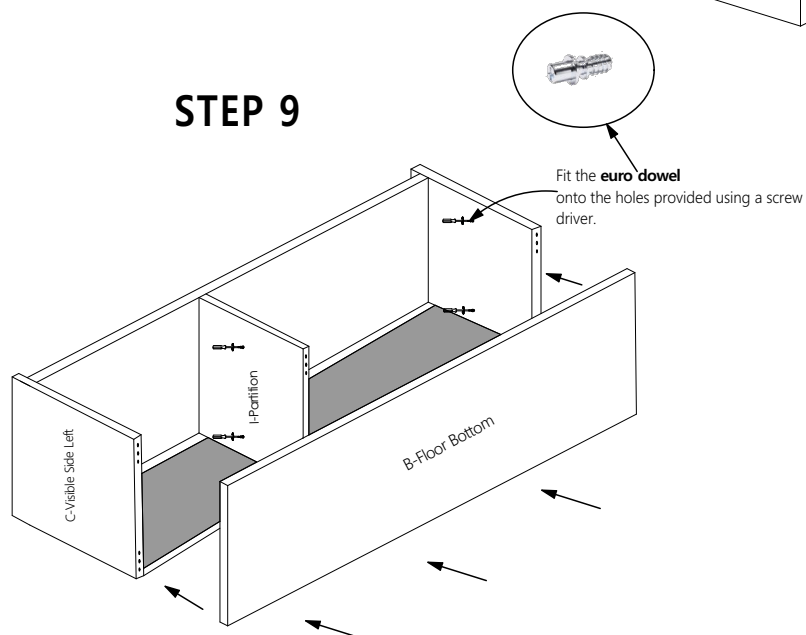

## STEP 10

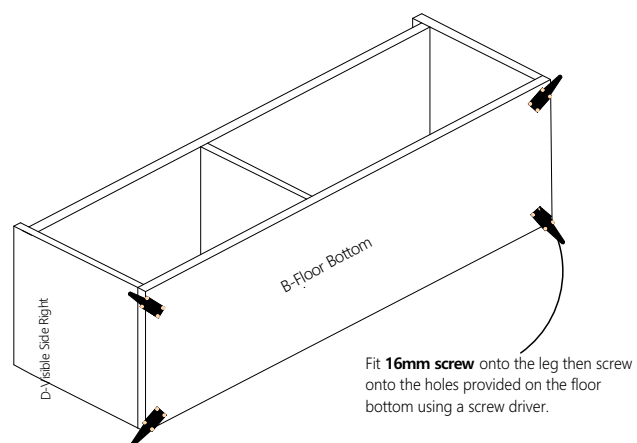

## STEP 11

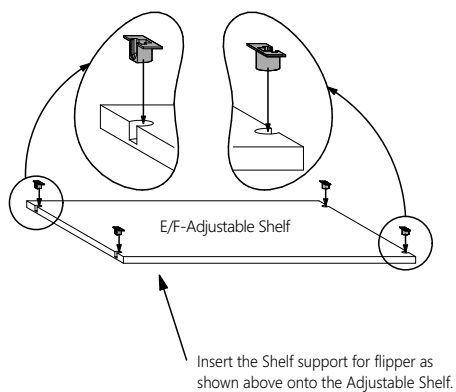

## STEP 12

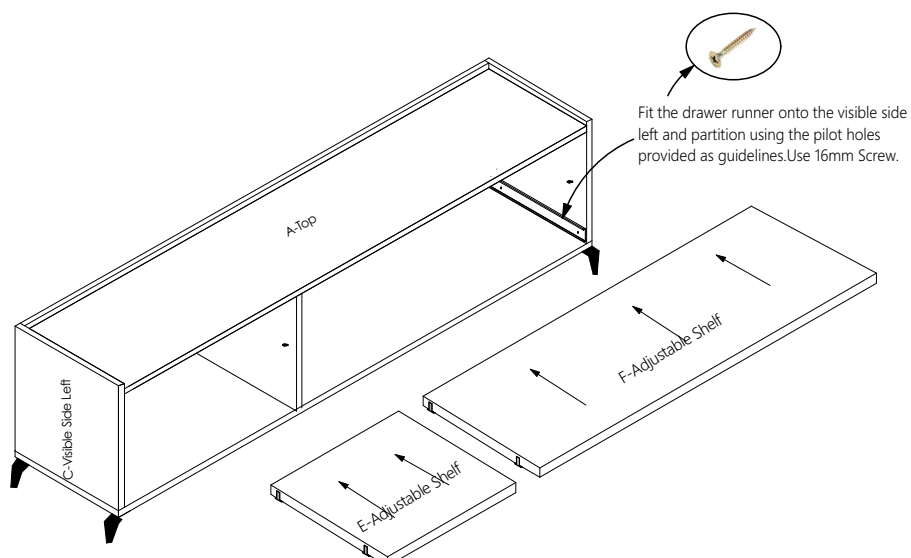

## STEP 13

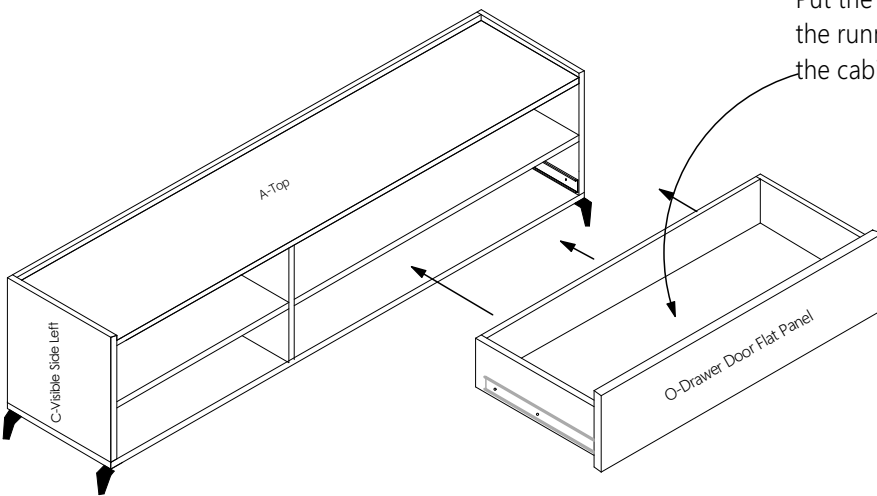

### HINGE ADJUSTMENT DETAILS

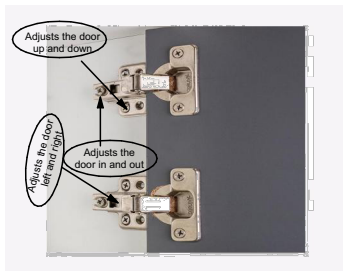

Put the drawer against the runners attached on the cabinet.

## STEP 14

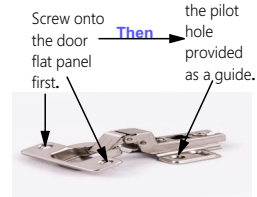
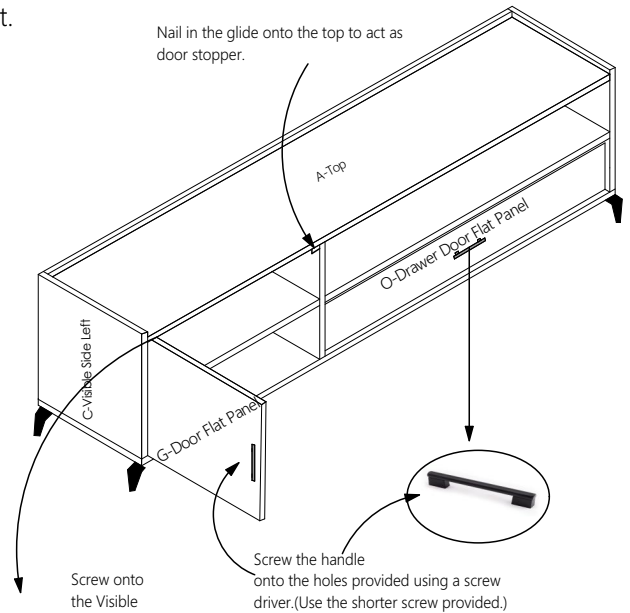

## STEP 15

