

EDGLINE QUICKLOC FLATPAX KITCHEN RANGE

ASSEMBLY GUIDE

BASE CABINET OVEN 600mm

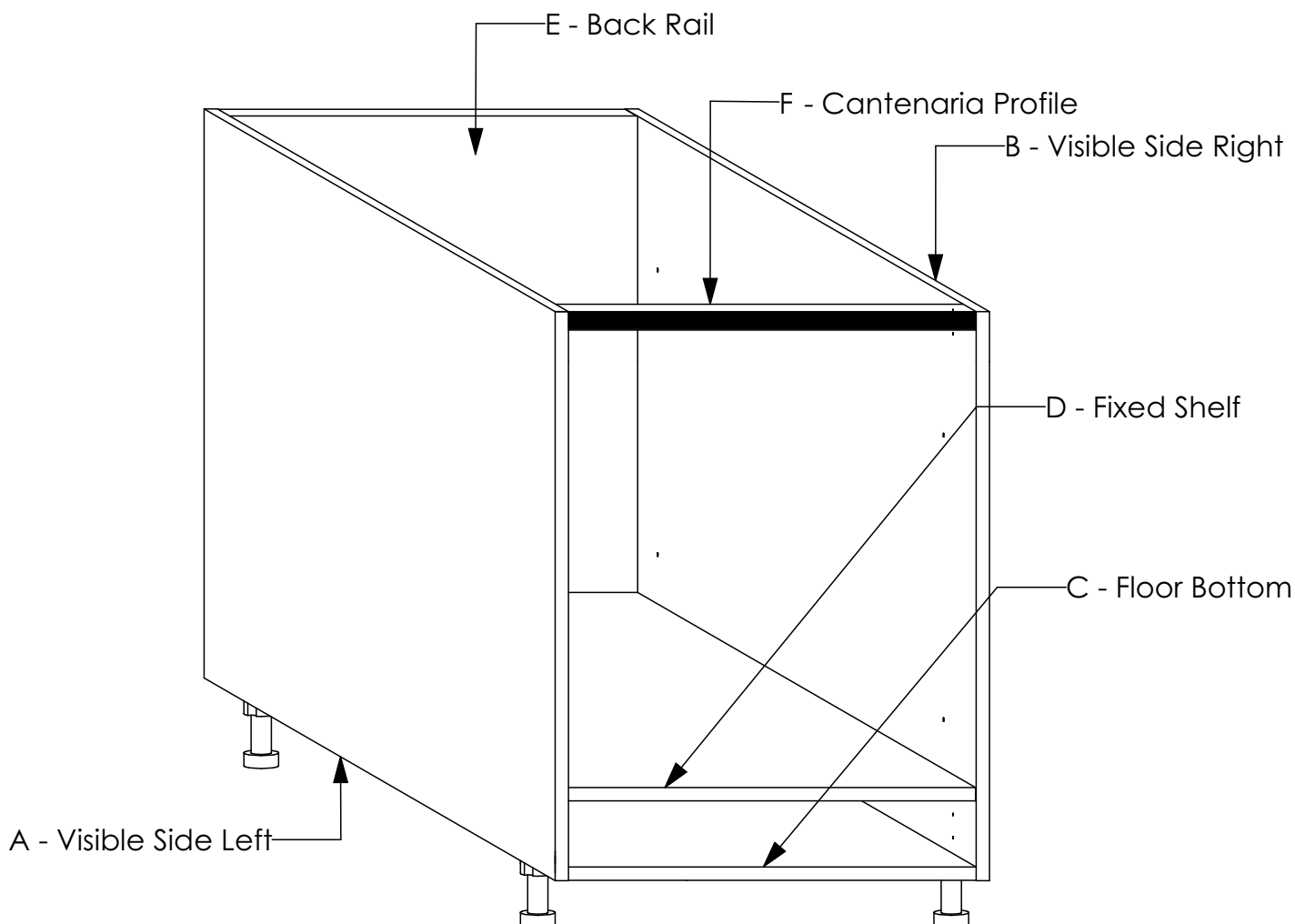

HARDWARE

TOTAL NUMBER OF PANELS: 5

PRODUCT	QTY	IMAGE
Sys5 Quickfit TL2 Dowel 8 x 34	10	
Sys5 Cam 3000 15 x 14 mm	10	
Wooden Dowel Titus 8 x 30 mm	20	
Screw 3.5 x 16mm	12	
Plinth Leg With Base H100mm Kit	4	
Cabinet Connecting Screw Kit	4	
Cantenaria-profile_Silver	1	
Clip and fix plate for cantenaria	2	

TOOLS REQUIRED



Screw Driver
(Pozidriv Head)



Cordless Drill

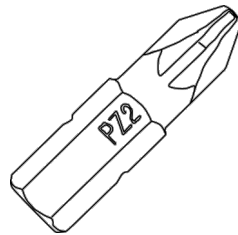

Pozi Bit (PZ2)

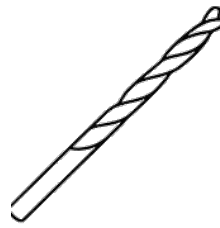

8mm Drill Bit



Rubber Mallet

GENERAL INSTRUCTIONS

1. Confirm that all panels (5) are in the package before assembling.
2. Check the white sticker on each panel for the labelling (A, B, C, D & E).
3. Ensure that the panels are laid on a non-abrasive surface when assembling.
4. Note that all panel connections are done using the system described below.

PANEL CONNECTION AND FASTENING

I

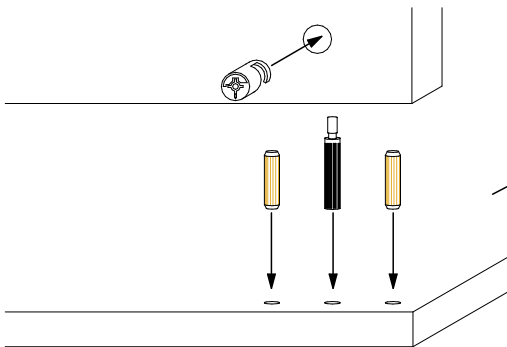

II

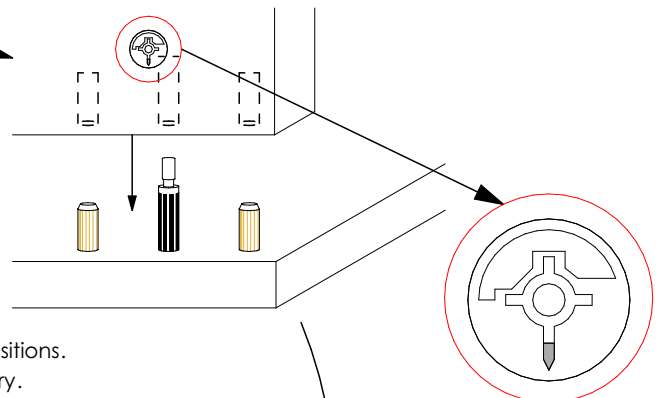

Det. 1

III

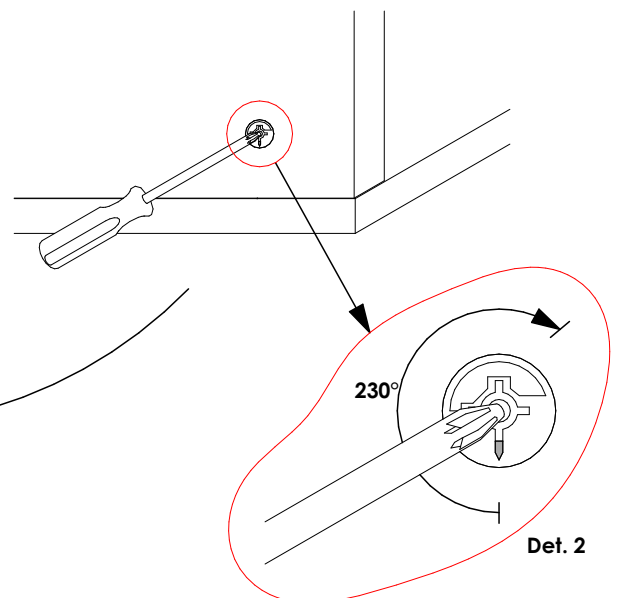

Det. 2

IV

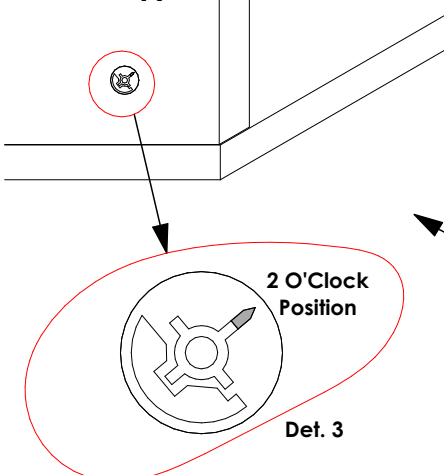

Det. 3

I - Insert the **Minifix (1)**, **Dufix (1)** and **wooden dowels (2)** in the shown positions. **Gently** knock in the **wooden dowels** using a rubber mallet where necessary.

II - Confirm that the **Minifix** orientation is as shown in **Det. 1** then connect the panels.

III - Using a **screw driver**, turn the **Minifix 230°** clockwise to fasten the panels together. Refer to **Det. 2**.

IV - See **Det. 3** for Minifix orientation when fastened. Reset the Minifix orientation to that shown in **Det. 1** to **disconnect** the panels.

PILOT HOLES KEY FOR SIDE PANELS

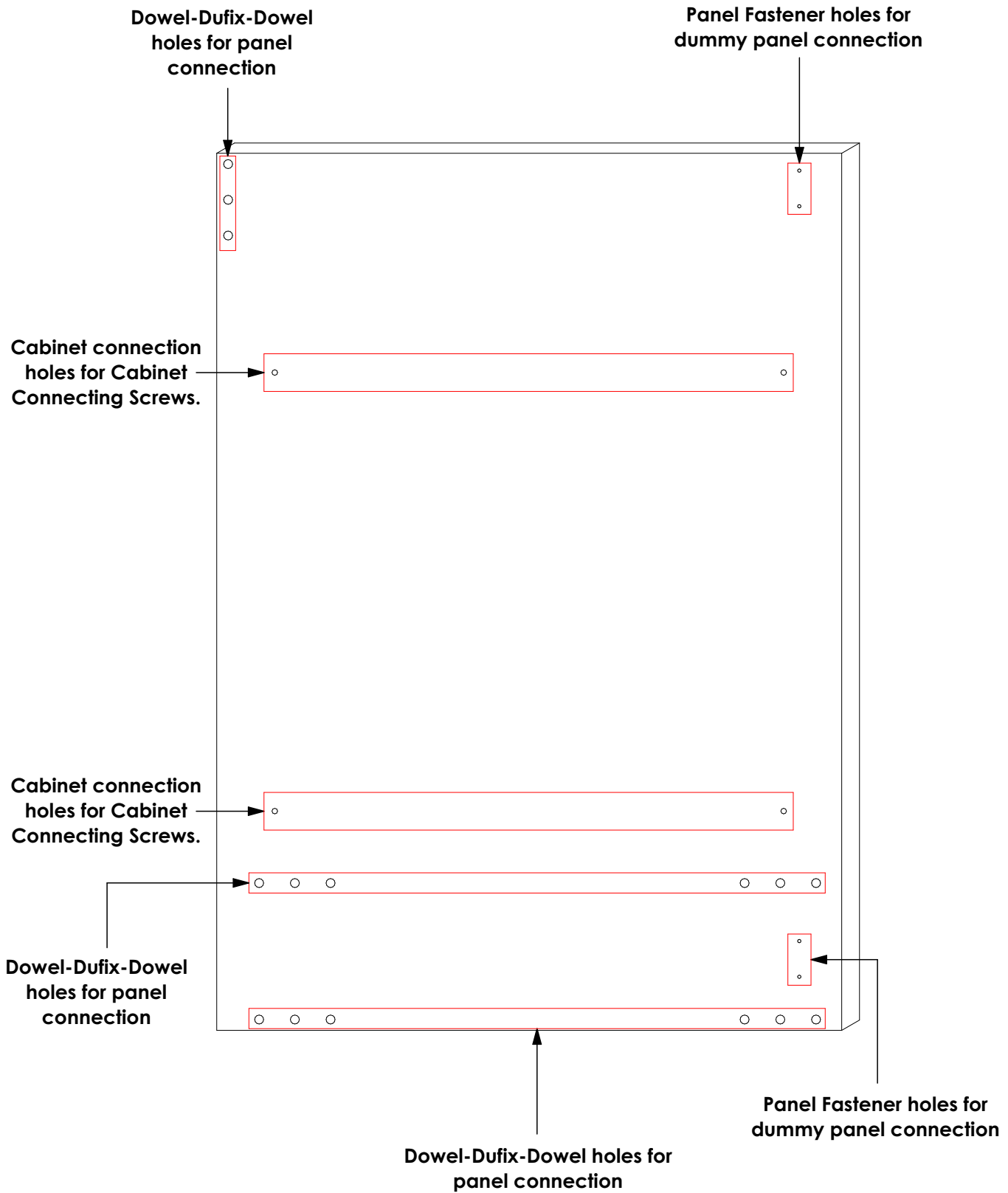

STEP 1

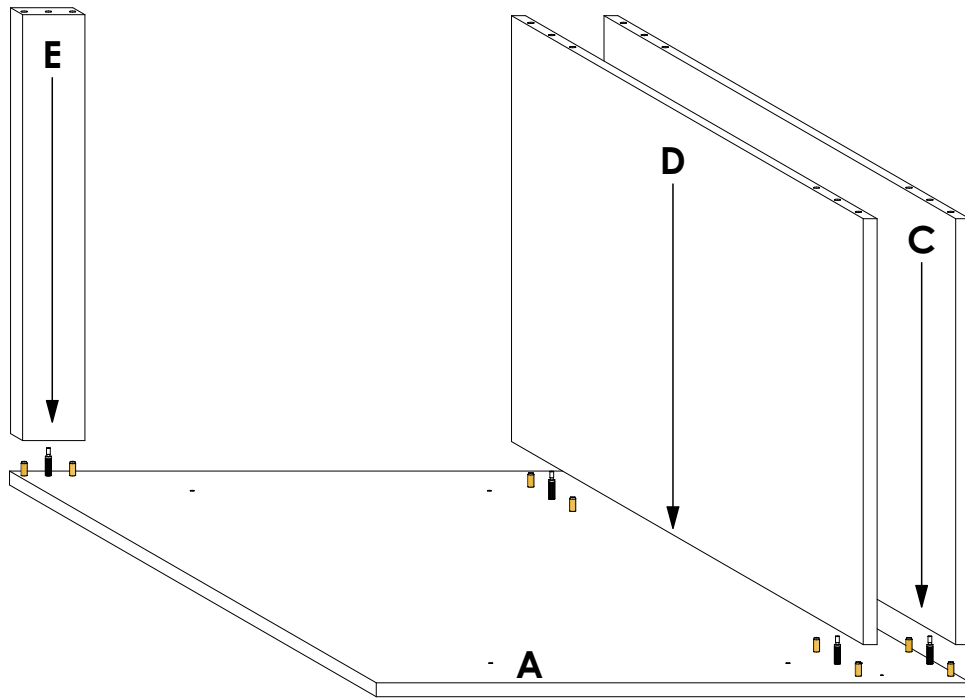

Connect panels **C, D & E** to panel **A** as shown. Refer to the holes and/or grooves on the diagram to determine the panel orientation.

STEP 2

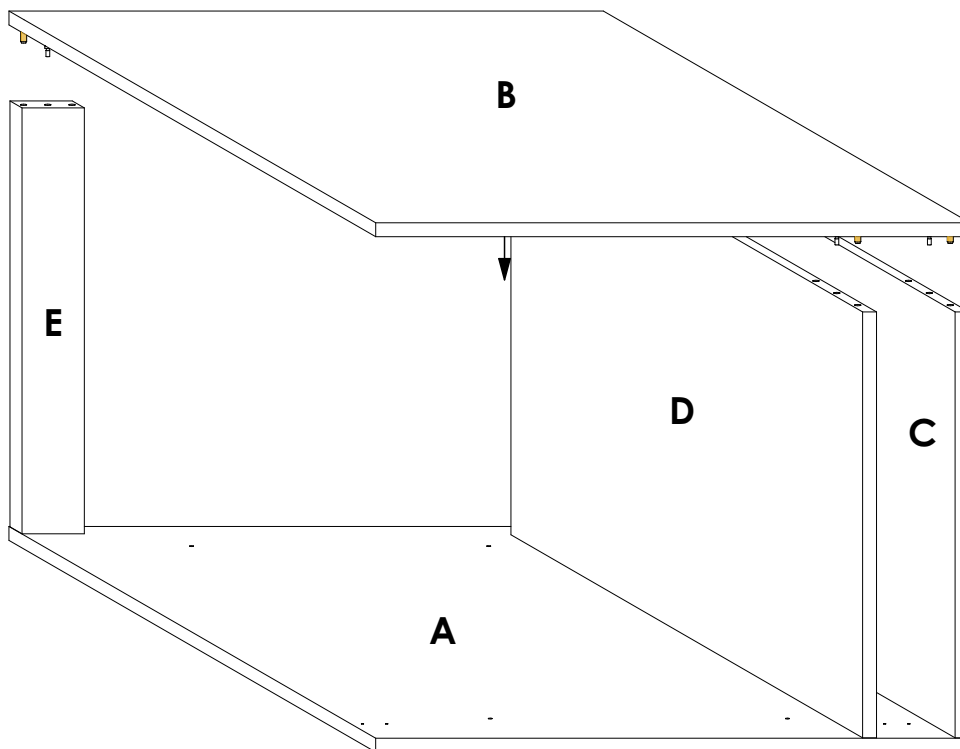

Connect panel **B** to panels **C, D & E** as shown. Refer to the holes and/or grooves on the diagram to determine the panel orientation.

STEP 3

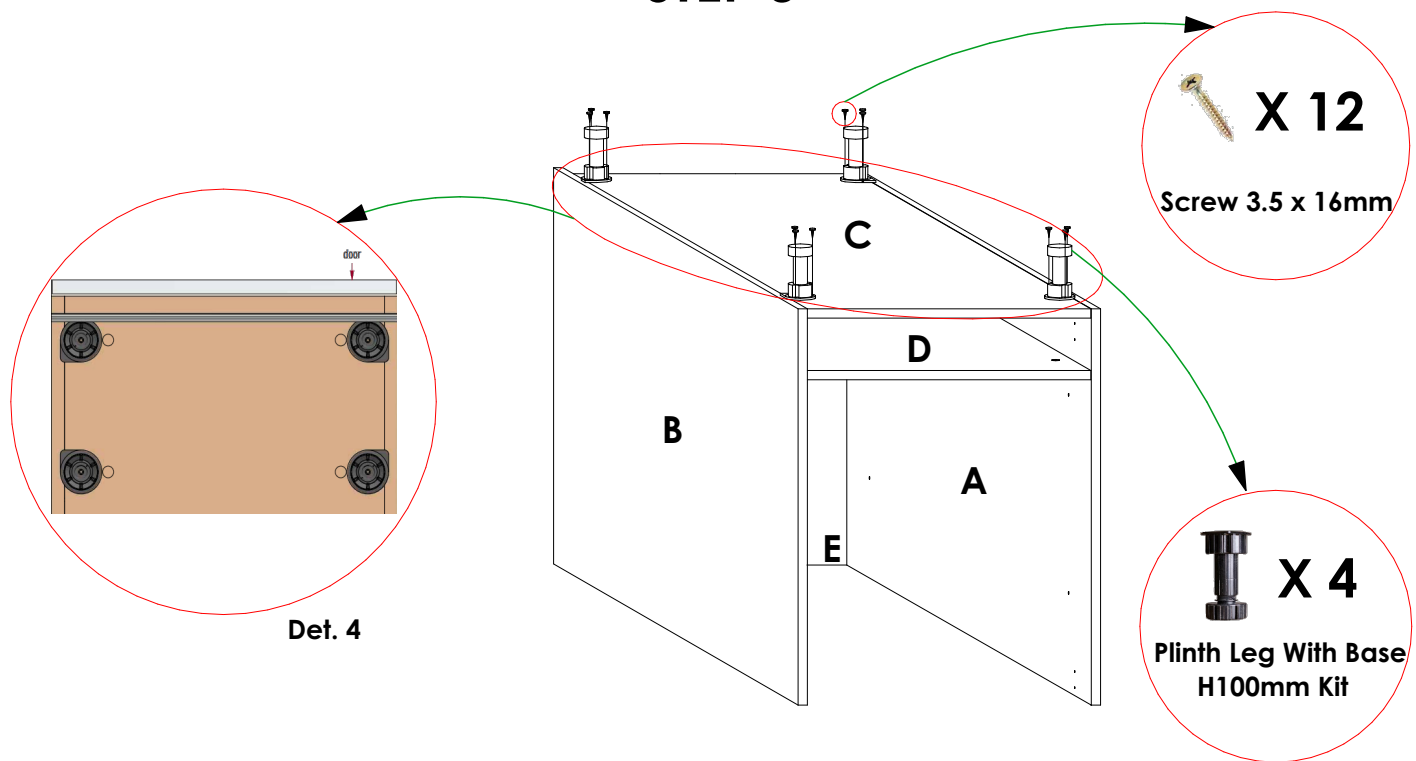

Flip the cabinet up-side down as shown. Place the four units of **Leg Adjustable Base 100mm** in the shown positions, aligning with the pre-drilled pilot holes on panel **C**. Ensure that the orientation is as shown in **Det. 4**. Using **Screw 3.5 X 16mm**, secure the legs onto panel **C**.

STEP 4

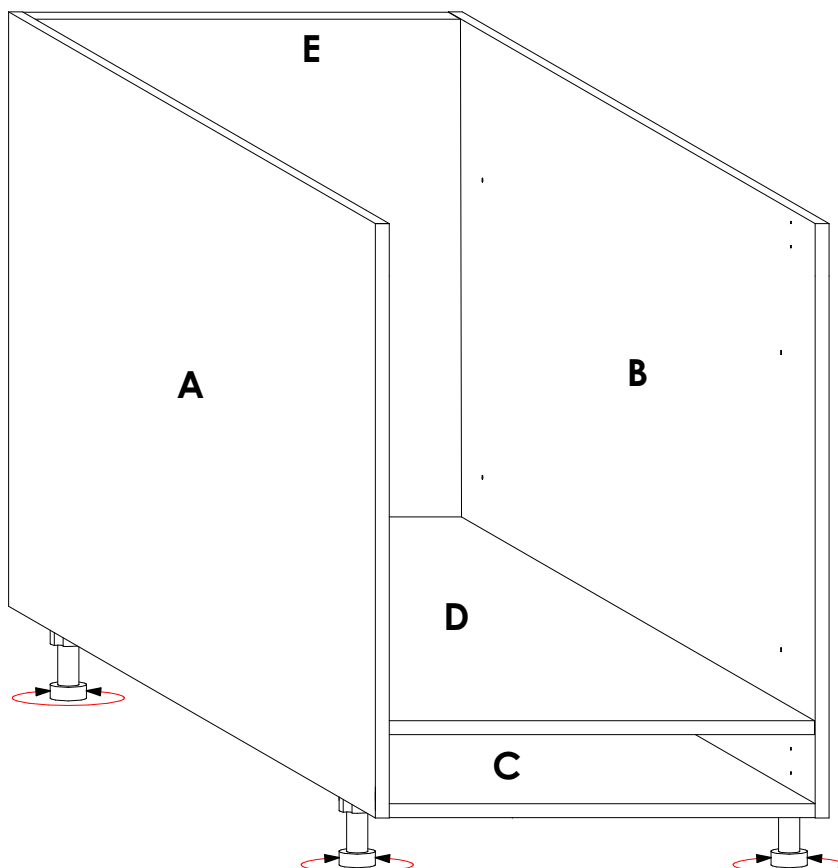

Flip the cabinet upright, place it in the desired position and adjust its height by rotating the base of the legs as shown to level. See the Door and Dummy Panel Installation guide for further instructions.

STEP 5

Fix the cantenaria profile as shown below. **Step 1**; Insert the end cap flush with the profile. **(View Det.5).** **Step 2**; Use the screw provided to securely fasten the end dowel to the profile and onto the panel A and panel E. **(View Det.6).** **Step 3**; Fix the cantenaria profile to the top using the special connecting plate. **(View Det.7)**

