

## GEDi FLOATING MEDIA UNIT 1800MM

| COMPONENTS |                    |     |
|------------|--------------------|-----|
| PART NO.   | DESCRIPTION        | QTY |
| A          | Top                | 1   |
| B          | Floor Bottom       | 1   |
| C          | Visible side left  | 1   |
| D          | Visible side Right | 1   |
| E,F,G      | Adjustable shelf   | 3   |
| H,I        | Partition          | 2   |
| J,K        | Door Flat Panel    | 2   |

| HARDWARE                       |   |     |
|--------------------------------|---|-----|
| ITEM                           | IMAGE   | QTY |
| Sys5 Cam 3000 15 x 14 mm       |    | 16  |
| Sys5 Quickfit TL2 Dowel 8 x 34 |    | 16  |
| Wooden Dowel Titus 8 x 30 mm   |    | 32  |
| APC 6 Hanger Kit               |    | 2   |
| 110 Degree Overlay Hinge       |    | 4   |
| Shelf Support Flipper 14mm Kit |   | 8   |
| Screws 4.0 x50MM               |  | 8   |
| Nail In Anchor                 |  | 8   |

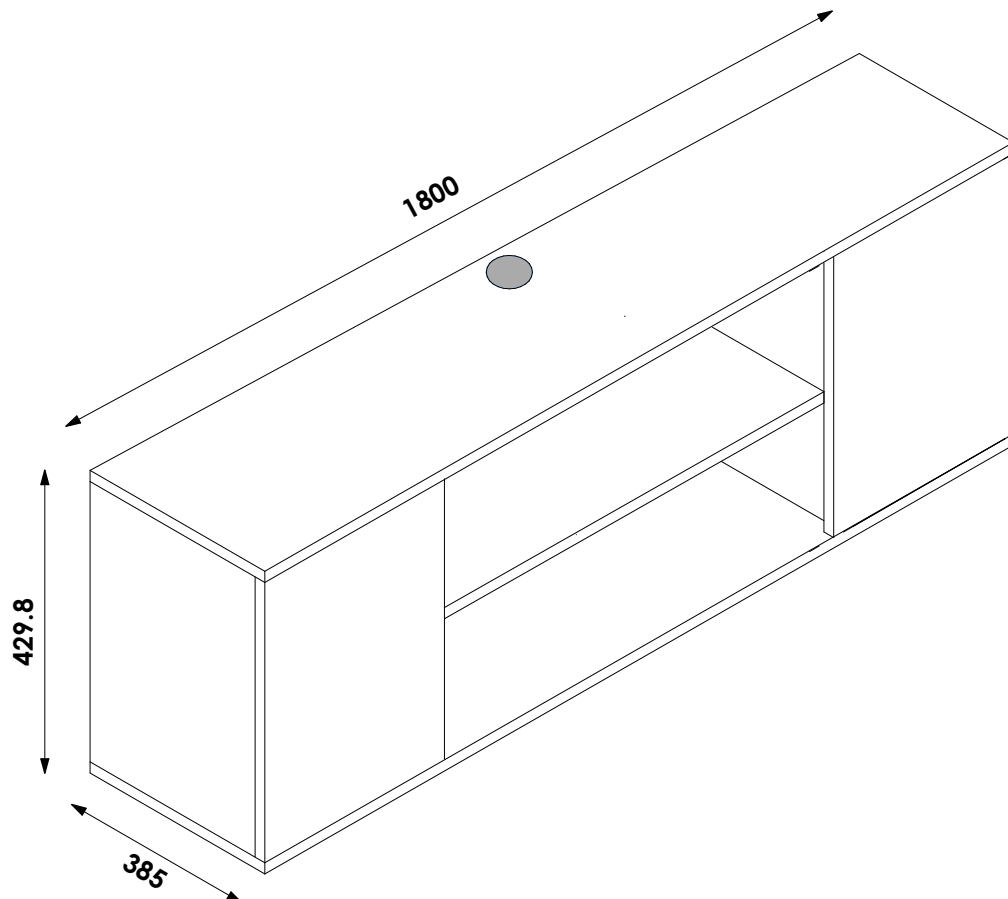

## GENERAL INSTRUCTIONS

1. Confirm that all panels (11) are in the package before assembling.
2. Check the white sticker on each panel for the labelling (A,B,C,D,E,F,G,H,I,J&K).
3. Ensure that the panels are laid on a non-abrasive surface when assembling.
4. Note that all panel connections are done using the system described below.

### PANEL CONNECTION AND FASTENING

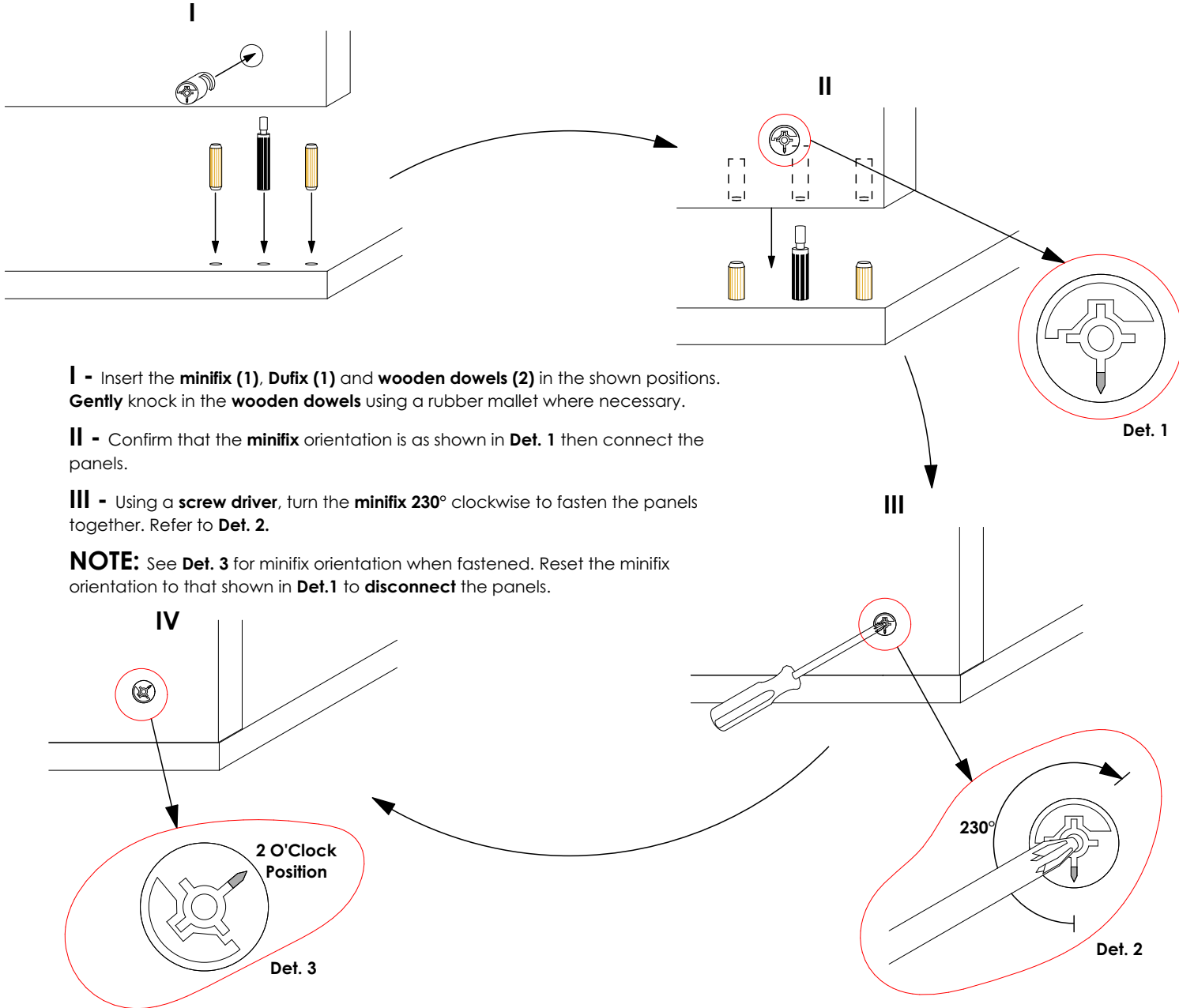

#### For an easy and enjoyable assembly:

Please read the assembly chart completely. Remove all the parts from the carton box and place them on a smooth surface. Make sure you have exactly all the parts and tools listed in the chart. Start assembling the products following the steps on the chart. Please keep the assembly chart for future reference.



**TWO PERSON  
ASSEMBLY  
REQUIRED.**

STEP 1

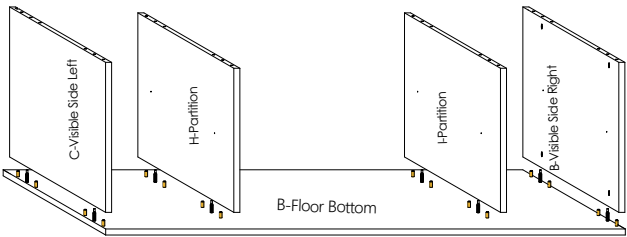

STEP 2

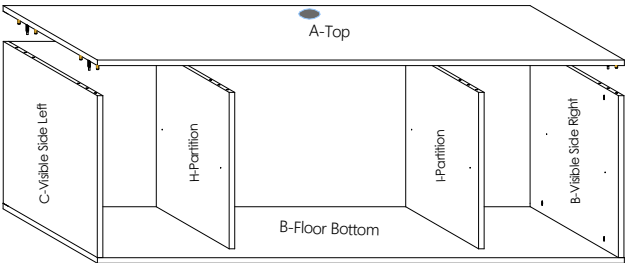

STEP 3

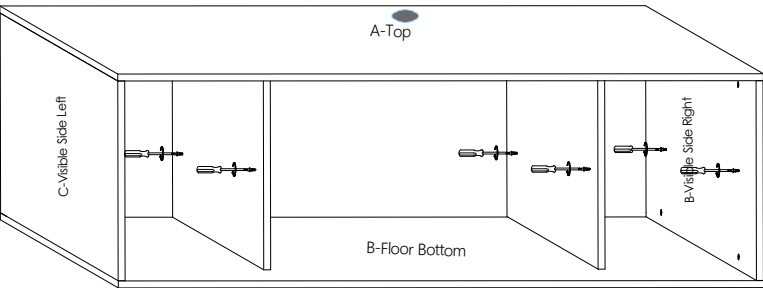

STEP 4

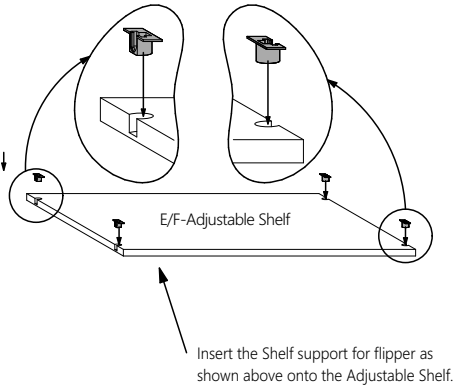

STEP 5

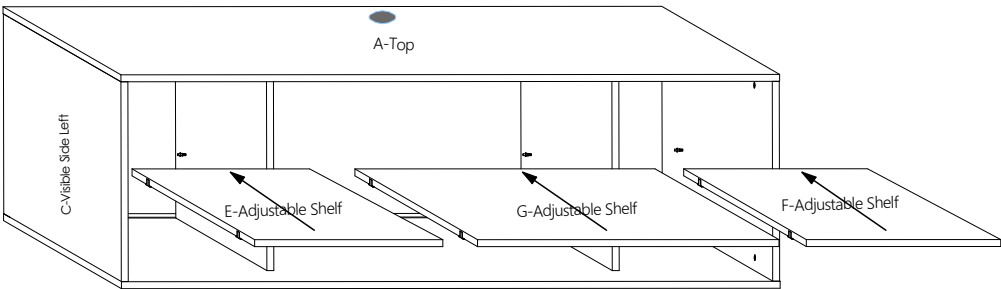

# ASSEMBLY SHEET - GEDI FLOATING MEDIA UNIT 1800MM

## STEP 6

Screw the hinge onto the holes provided using a screw driver and use **16mm Screws**.

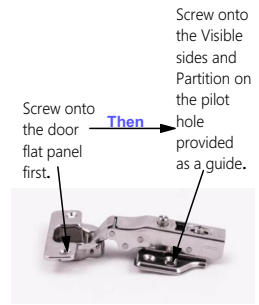
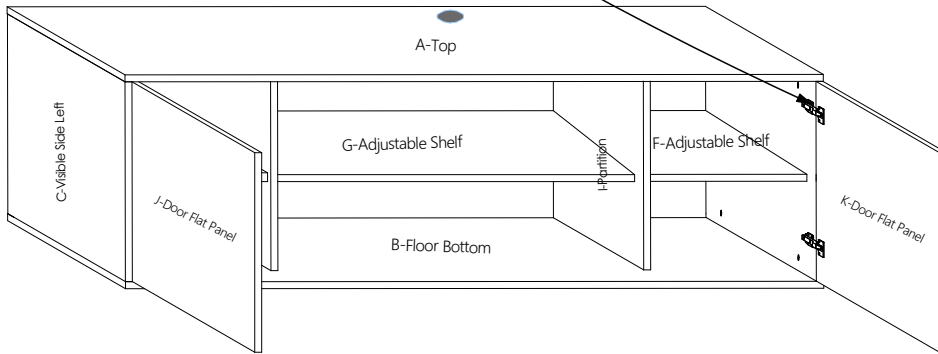

### HINGE ADJUSTMENT DETAILS

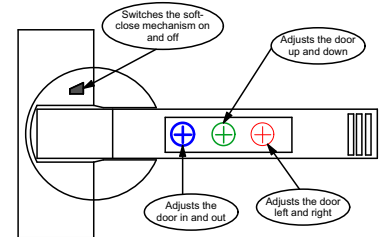

## STEP 7

### APC 6 INSTALLATION GUIDE

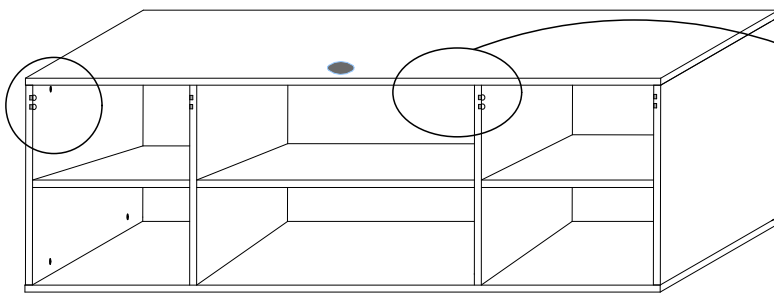

BACK SIDE OF THE GEDI FLOATING UNIT

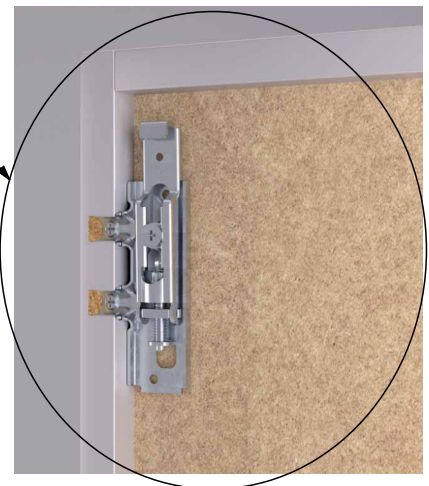

### INSTALLATION UNDER THE CABINET TOP

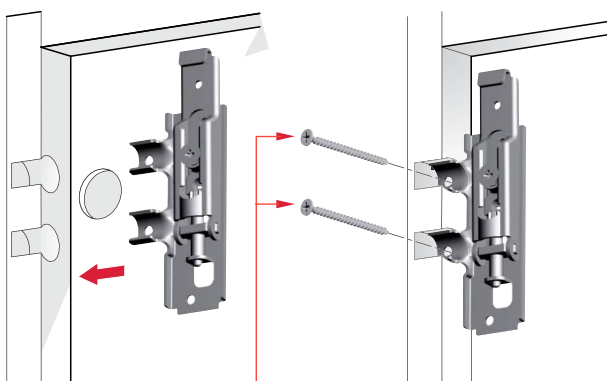

recommended fixing countersunk head wood screws  $\varnothing 3 \times 40$  mm

### INSTALLATION ON THE WALL

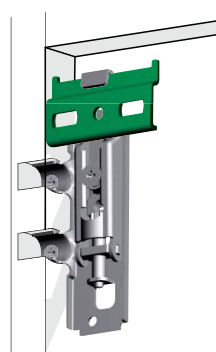

### COVER CAP INSERTING

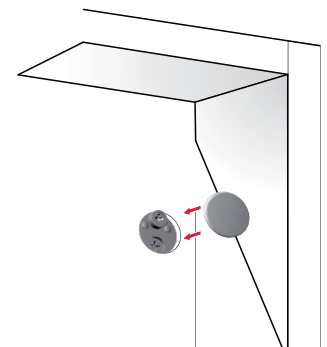

It is the responsibility of the customer:  
 - to ensure that the wall is of a suitable quality to hold the unit fixing in place.  
 - to use the proper hardware fittings according to the construction of the wall.

# ASSEMBLY SHEET - GEDI FLOATING MEDIA UNIT 1800MM

## ADJUSTMENTS

