

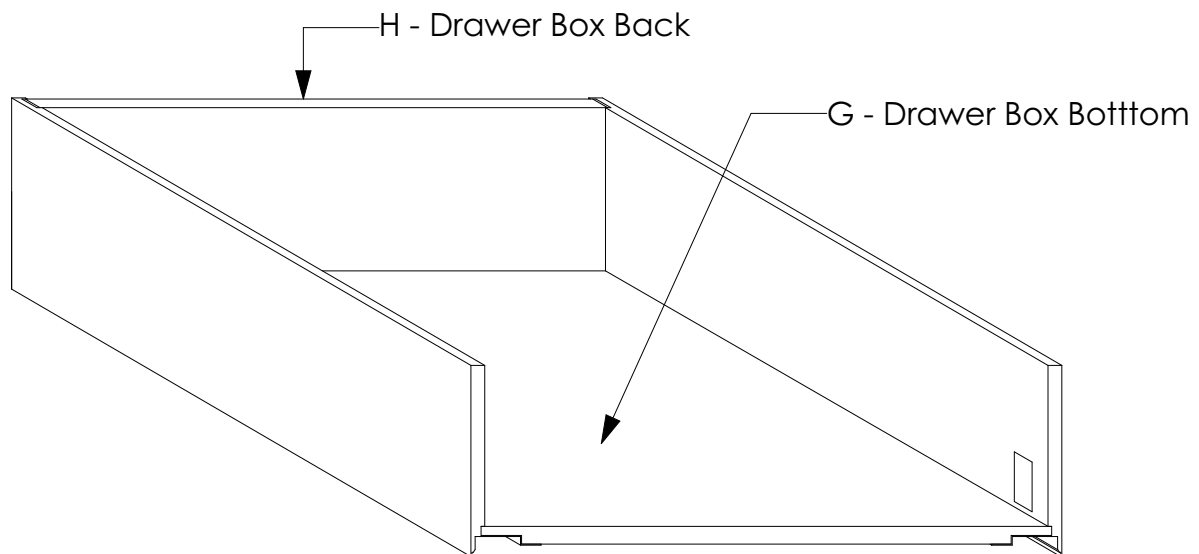

# QUICKLOC FLATPAX KITCHEN RANGE ASSEMBLY GUIDE DTC MAGIC STAR DRAWER BOX HEIGHT 2



## HARDWARE

**TOTAL NUMBER OF PANELS: 2**

PRODUCT	QTY	IMAGE
Back Fixing Bracket Left /Right	1 Pair	
Drawer Sides Left/Right	1 Pair	
Screw 3.5 x 16mm	24	
Front Fixing Bracket	2	
Runners Left/Right	1 Pair	
Cover Cap for Drawer Sides	2 of each	

## TOOLS REQUIRED

				<b>GENERAL INSTRUCTIONS</b>
Screw Driver (Pozi driv Head)	Cordless Drill	Pozi Bit (PZ2)	Rubber Mallet	<ol style="list-style-type: none"><li>1. Confirm that all panels (2) and hardware are in the package before assembling.</li><li>2. Check the white sticker on each panel for the labelling (G &amp; H).</li><li>3. Ensure that the panels are laid on a non-abrasive surface when assembling.</li></ol>

Drawer Assembly

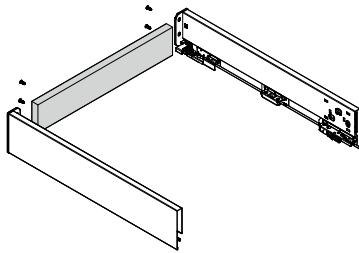

Back assembly

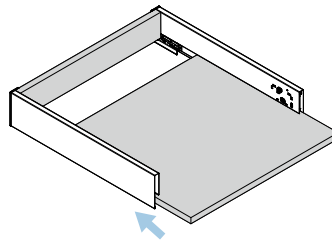

Bottom assembly

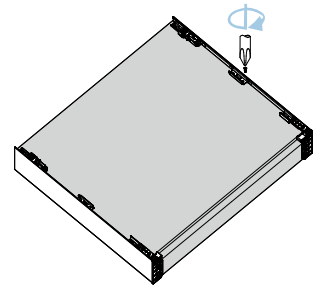

Fix screws

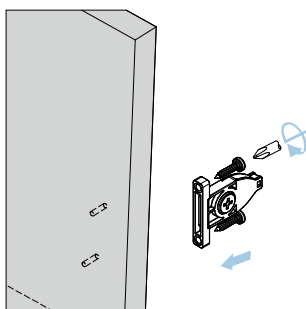

Front assembly

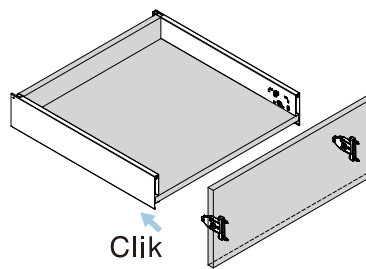

Click

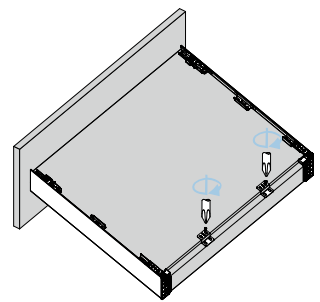

Fixing-brackets assembly

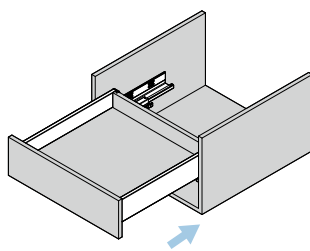

Slide into the cabinet

### Adjustments for Lower/Medium Drawer(M/K Height)

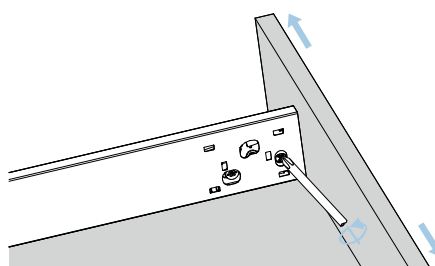

Left&right adjustment

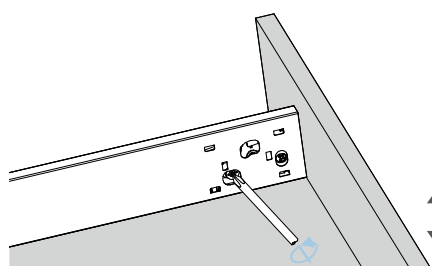

Up&down adjustment

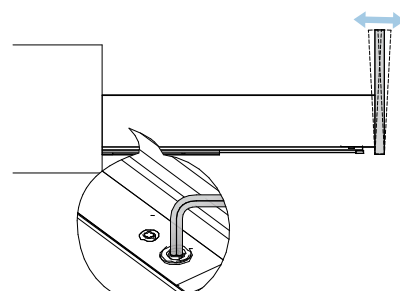

Tilt adjustment (by M3 Allen key)

### Removal for Lower/Medium Drawer(M/K Height)

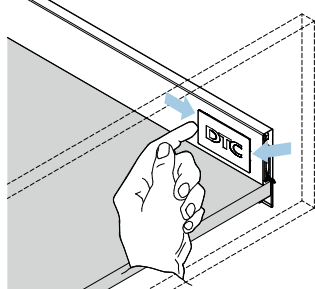

Tip up the cover and pull out

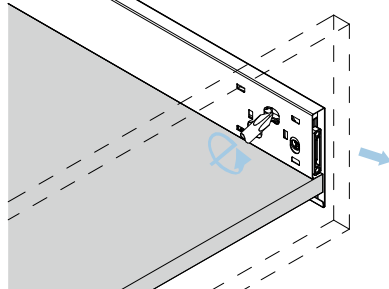

Turn screw driver to release the drawer front

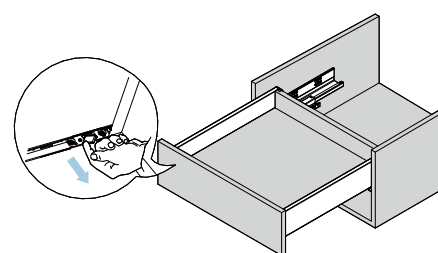

Press the locking device under drawer bottom and pull out the drawer

### Adjustments for High Drawer/Super High Drawer (C/F Height)

